



# EDGE Wet INSTALLATION INSTRUCTIONS

EV3 Wet LED Recessed FL Installation .....	2-6
EV6 Wet LED Recessed FL Installation .....	7-11
EX3/ EX6 Wet LED Surface Mount Installation .....	12-15
EX3/ EX6 Wet LED Wet Pendant Pipe Installation .....	16-19
EX3/ EX6 Wet LED Wall Mount Installation .....	20-23
Lens Detail.....	24-25



# EDGE Wet 3 LED RECESSED FL MOUNT INSTALLATION

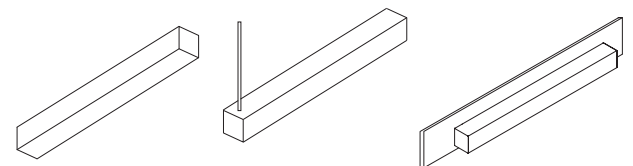
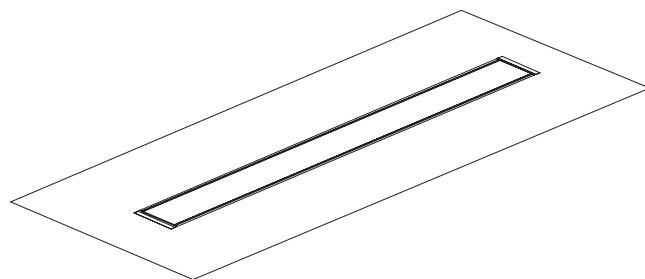

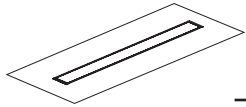

**EDGE**  
EVOLUTION

**3 WET**

# LED Recessed FL Mount Instructions

*LED Module does not need to be removed for installation*

## Step 1:

### Layout/ Dimensions

1. Layout fixtures and blocking locations.
2. Layout and install junction boxes and whip out.
3. Install blocking to structure using rough in dimensions.
4. Install ceiling material.
5. Cut out the fixture/row rough-in.

Cross Section View

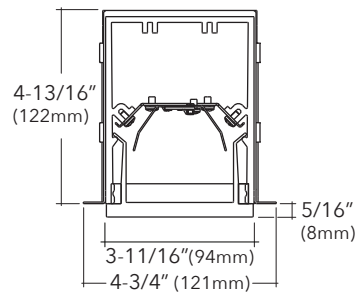

**Minimum wall opening = 4"**  
**Recommended wall opening = 4-1/4"**

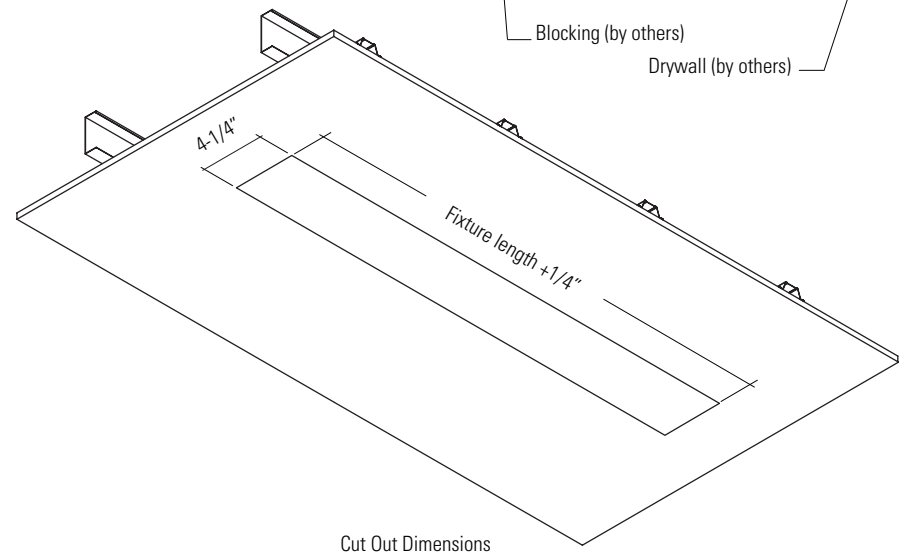
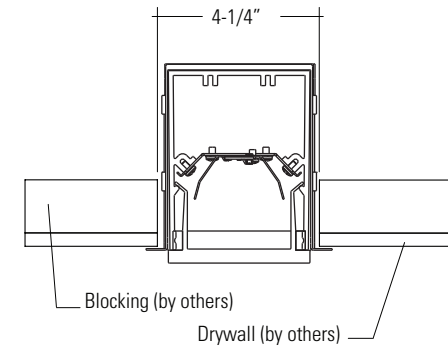

Cut Out Dimensions



1. This product must be installed in accordance with applicable installation and electrical codes by a professional familiar with the construction and operation of the product.
2. Minimum 90°C supply conductors
3. All electrical connections must be performed by a certified electrician to applicable local and national electrical codes.

4. Fixtures must be mounted directly to structure.
5. The holding strength of AC cables cannot be guaranteed if the cables are damaged in any way.
6. All of Pinnacle's packaging is recyclable with the exception of the straps on the pallets. Please reach out to the factory if you need assistance in recycling any packaging components.

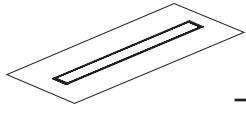

**EDGE**  
EVOLUTION

3 WET

## LED Recessed FL Mount Instructions

*LED Module does not need to be removed for installation*

### Step 2:

#### Fixture Prep

1. Ensure proper support behind fixture (see chart on last page for mounting locations)
2. Using flat thin tool carefully remove Lens so as not to damage lens or fixture.
3. Remove Wire Cover Plate.

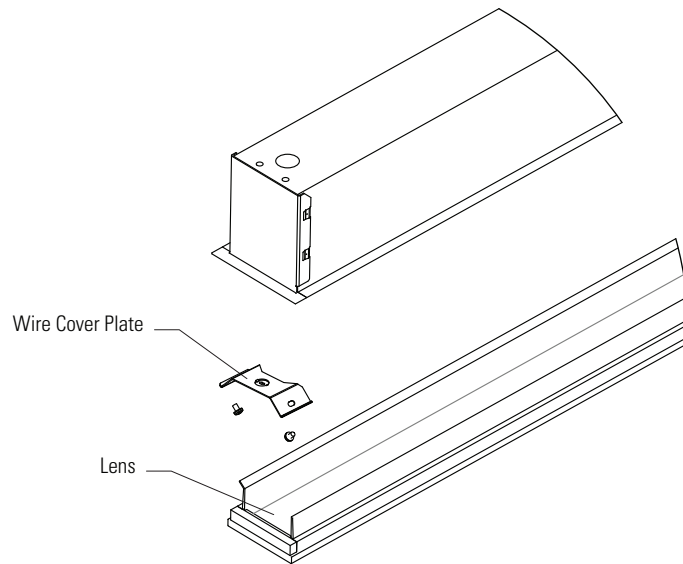

### Step 3:

#### Mounting and Power

1. Install Wet rated Conduit fitting (by others).
2. Install fixture using two (2) mounting screws, one (1) at each end of fixture. (screws by others).
3. Make necessary connections between fixture and building power using wet rated flex conduit ensuring all wires are properly matched.
4. Reinstall Wire Cover Plate and lens.

**(Note: If joining fixtures to make a row, all fixtures in row required mounting hardware at both ends of fixture.)**

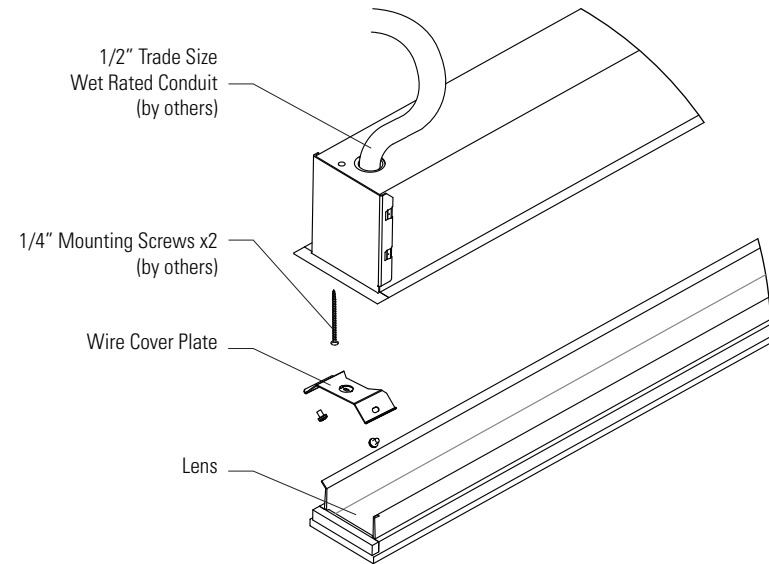

1. This product must be installed in accordance with applicable installation and electrical codes by a professional familiar with the construction and operation of the product.
2. Minimum 90°C supply conductors
3. All electrical connections must be performed by a certified electrician to applicable local and national electrical codes.

4. Fixtures must be mounted directly to structure.
5. The holding strength of AC cables cannot be guaranteed if the cables are damaged in any way.
6. All of Pinnacle's packaging is recyclable with the exception of the straps on the pallets. Please reach out to the factory if you need assistance in recycling any packaging components.

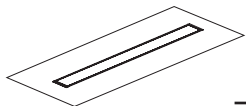

**EDGE**  
EVOLUTION

**3 WET**

**LED**

# Recessed FL Mount Instructions

*LED Module does not need to be removed for installation*

## Optional Step 4:

### Connecting Fixtures Together

1. Remove Lenses and Wire Cover plates (use flat tool to remove lens).
2. Run wires through the Conduit Nipple and the Conduit Nuts prior to wiring fixtures together.
3. Make necessary wiring connections between fixtures ensuring all wires are properly matched.
4. Slide fixtures together, use Joining Biscuits to align fixtures.
5. Install Alignment Bracket, use to hold Conduit Nipples while tightening fixtures together.
6. Reinstall Wire Cover Plates and Lenses.

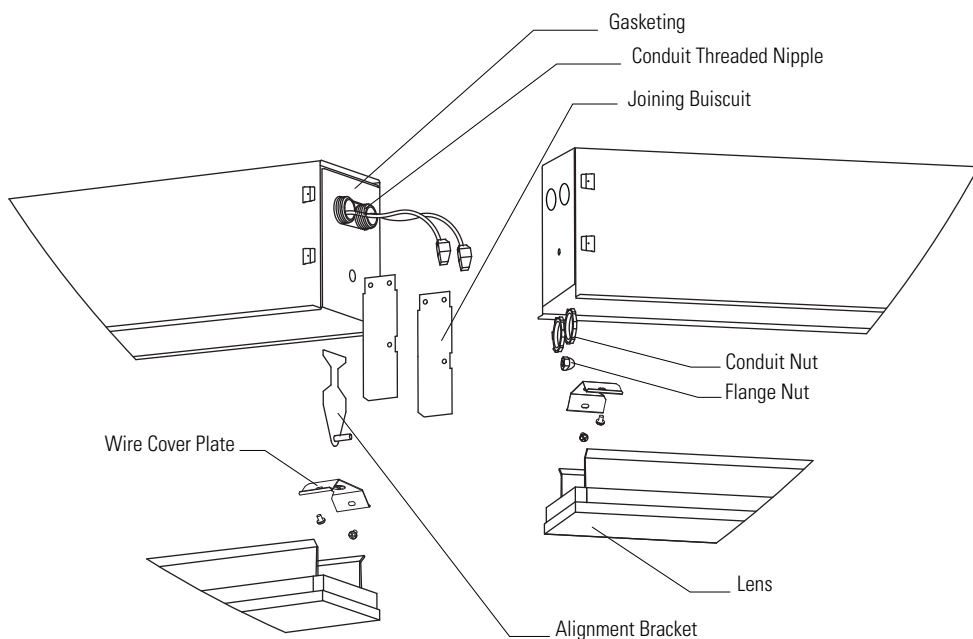

## Optional Step 5:

### End Feed

1. Remove Lens and Wire Cover plates (use flat tool to remove lens).
2. Connect Wet Rated 1/2" conduit to end of fixture.
3. Pull wires through and make necessary wire connections.
4. Reinstall wire cover and lens.

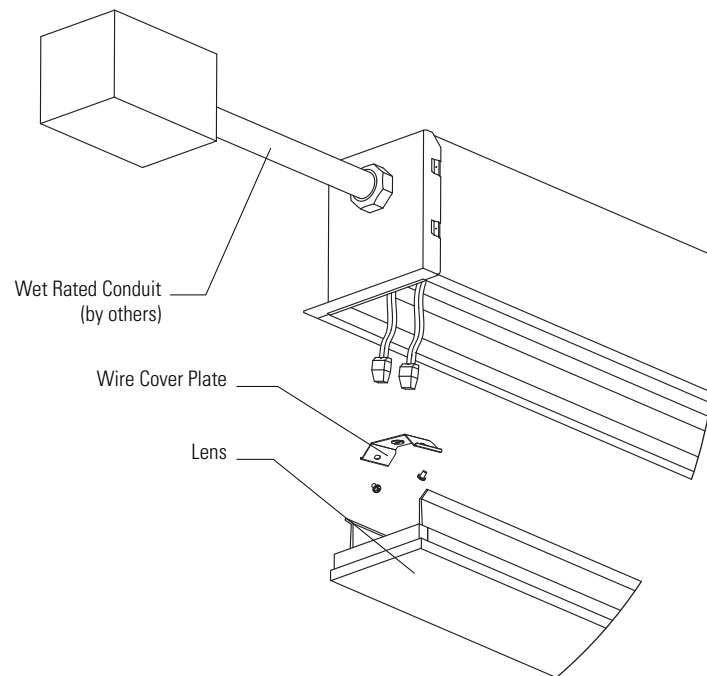

1. This product must be installed in accordance with applicable installation and electrical codes by a professional familiar with the construction and operation of the product.
2. Minimum 90°C supply conductors
3. All electrical connections must be performed by a certified electrician to applicable local and national electrical codes.

4. Fixtures must be mounted directly to structure.
5. The holding strength of AC cables cannot be guaranteed if the cables are damaged in any way.
6. All of Pinnacle's packaging is recyclable with the exception of the straps on the pallets. Please reach out to the factory if you need assistance in recycling any packaging components.

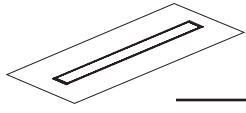

**EDGE**  
EVOLUTION

3 WET

# LED Recessed FL Mount Instructions

*LED Module does not need to be removed for installation*

## EXAMPLE:

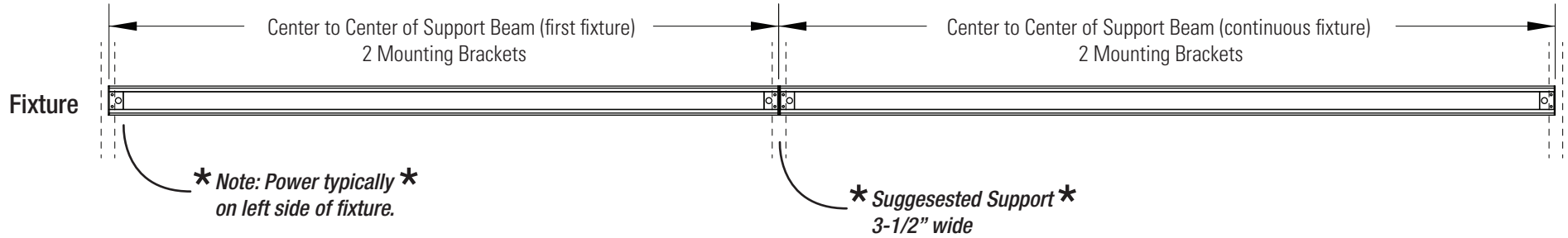

## Mounting Details

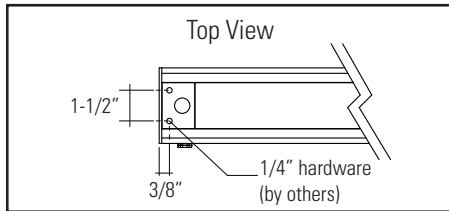

**\*Use one mounting hole at each mount location.\***

## First/ Independent Fixture Mounting Example

2'	27-1/8" center to center of support
3'	39" center to center of support
4'	50-3/4" center to center of support
5'	62-5/8" center to center of support
6'	74-5/8" center to center of support
7'	86-1/2" center to center of support
8'	98-3/8" center to center of support

## Intermediate/ End Fixture Mounting Example

2'	27-1/8" center to center of support
3'	39" center to center of support
4'	50-3/4" center to center of support
5'	62-5/8" center to center of support
6'	74-5/8" center to center of support
7'	86-1/2" center to center of support
8'	98-3/8" center to center of support



1. This product must be installed in accordance with applicable installation and electrical codes by a professional familiar with the construction and operation of the product.
2. Minimum 90°C supply conductors
3. All electrical connections must be performed by a certified electrician to applicable local and national electrical codes.

4. Fixtures must be mounted directly to structure.
5. The holding strength of AC cables cannot be guaranteed if the cables are damaged in any way.
6. All of Pinnacle's packaging is recyclable with the exception of the straps on the pallets. Please reach out to the factory if you need assistance in recycling any packaging components.





# EDGE Wet 6

LED  
RECESSED FL MOUNT INSTALLATION

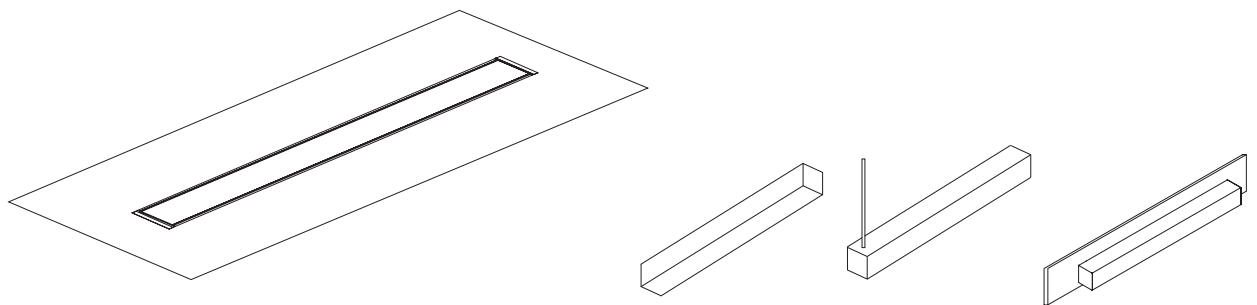

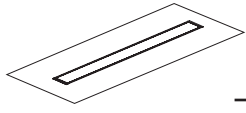

**EDGE**  
EVOLUTION

**6 WET**

# LED Recessed FL Mount Instructions

*LED Module does not need to be removed for installation*

## Step 1:

### Layout/ Dimensions

1. Layout fixtures and blocking locations.
2. Layout and install junction boxes and whip out.
3. Install blocking to structure using rough in dimensions.
4. Install ceiling material.
5. Cut out the fixture/row rough-in.

Cross Section View

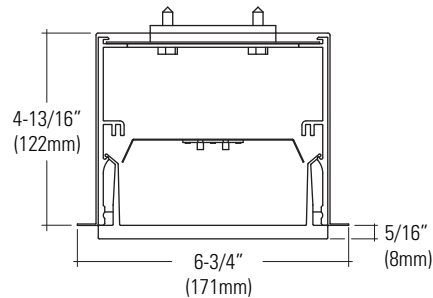

**Minimum wall opening = 6"**  
**Recommended wall opening = 6-1/4"**

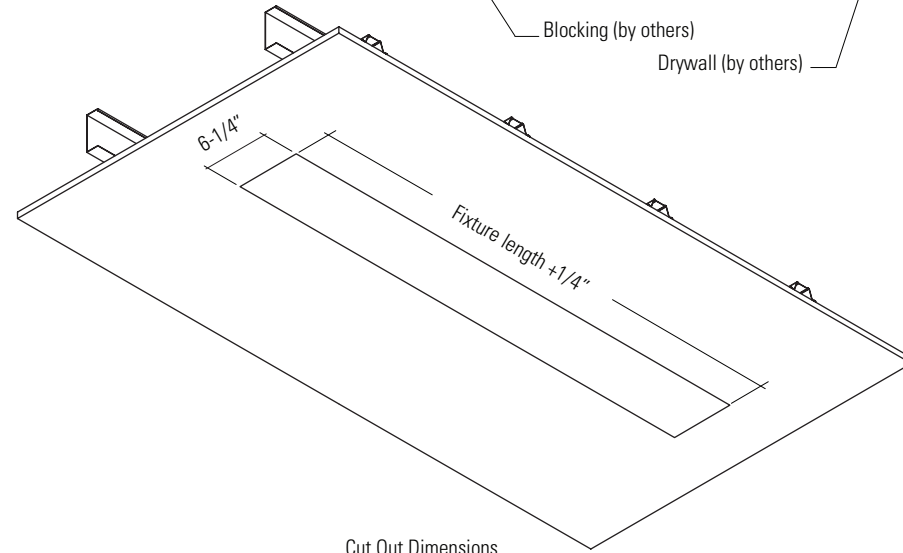
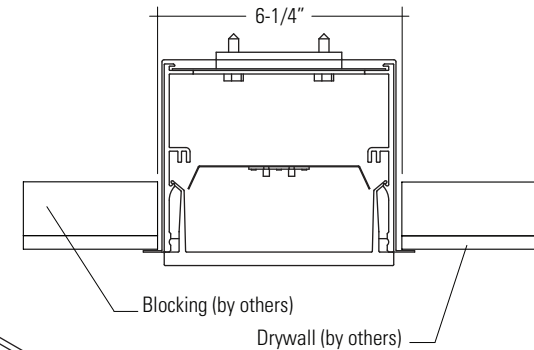

Cut Out Dimensions



1. This product must be installed in accordance with applicable installation and electrical codes by a professional familiar with the construction and operation of the product.
2. Minimum 90°C supply conductors
3. All electrical connections must be performed by a certified electrician to applicable local and national electrical codes.

4. Fixtures must be mounted directly to structure.
5. The holding strength of AC cables cannot be guaranteed if the cables are damaged in any way.
6. All of Pinnacle's packaging is recyclable with the exception of the straps on the pallets. Please reach out to the factory if you need assistance in recycling any packaging components.



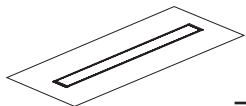

**EDGE**  
EVOLUTION

6 WET

## LED Recessed FL Mount Instructions

*LED Module does not need to be removed for installation*

### Step 2:

#### Fixture Prep

1. Ensure proper support behind fixture (see chart on last page for mounting locations)
2. Using flat thin tool carefully remove Lens so as not to damage lens or fixture.
3. Remove Wire Cover Plate.

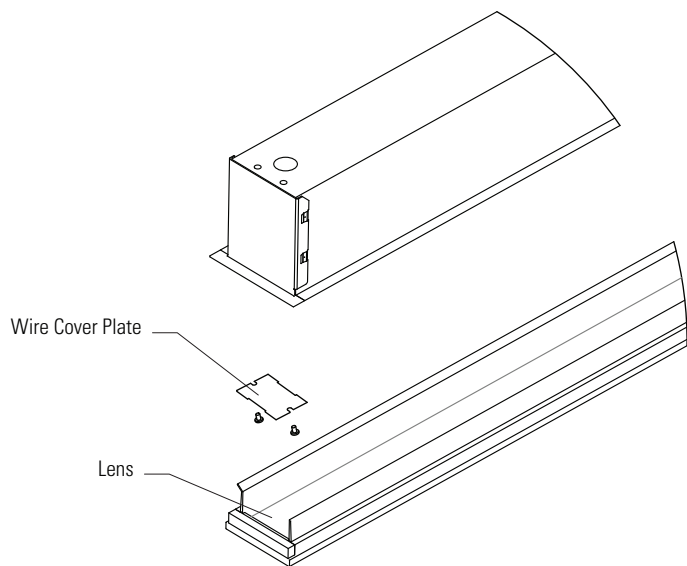

### Step 3:

#### Mounting and Power

1. Install Wet rated Conduit fitting (by others).
2. Install fixture using two (2) mounting screws, one (1) at each end of fixture. (screws by others).
3. Make necessary connections between fixture and building power using wet rated flex conduit ensuring all wires are properly matched.
4. Reinstall Wire Cover Plate and lens.

**(Note: If joining fixtures to make a row, all fixtures in row required mounting hardware at both ends of fixture.)**

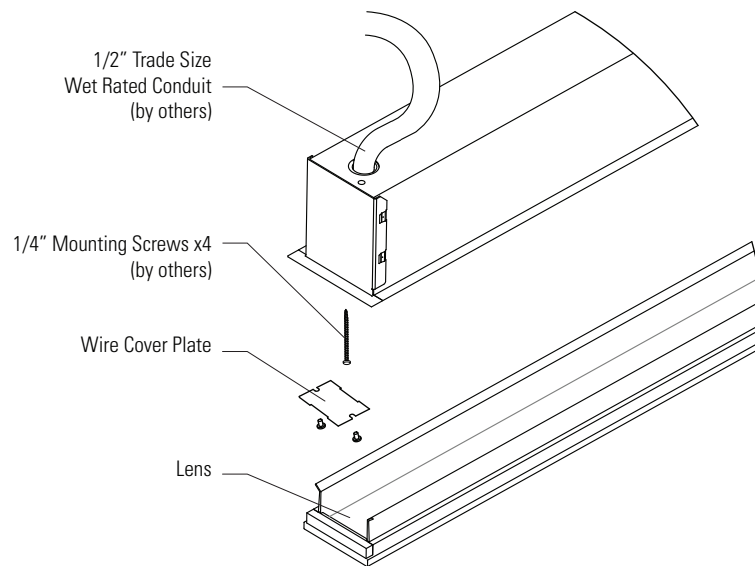

1. This product must be installed in accordance with applicable installation and electrical codes by a professional familiar with the construction and operation of the product.
2. Minimum 90°C supply conductors
3. All electrical connections must be performed by a certified electrician to applicable local and national electrical codes.

4. Fixtures must be mounted directly to structure.
5. The holding strength of AC cables cannot be guaranteed if the cables are damaged in any way.
6. All of Pinnacle's packaging is recyclable with the exception of the straps on the pallets. Please reach out to the factory if you need assistance in recycling any packaging components.

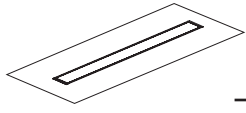

**EDGE**  
EVOLUTION

**6 WET**

**LED**

# Recessed FL Mount Instructions

*LED Module does not need to be removed for installation*

## Optional Step 4:

### Connecting Fixtures Together

1. Remove Lenses and Wire Cover plates (use flat tool to remove lens).
2. Run wires through the Conduit Nipple and the Conduit Nuts prior to wiring fixtures together.
3. Make necessary wiring connections between fixtures ensuring all wires are properly matched.
4. Slide fixtures together, use Joining Biscuits to align fixtures.
5. Install Alignment Bracket, use to hold Conduit Nipples while tightening fixtures together.
6. Reinstall Wire Cover Plates and Lenses.

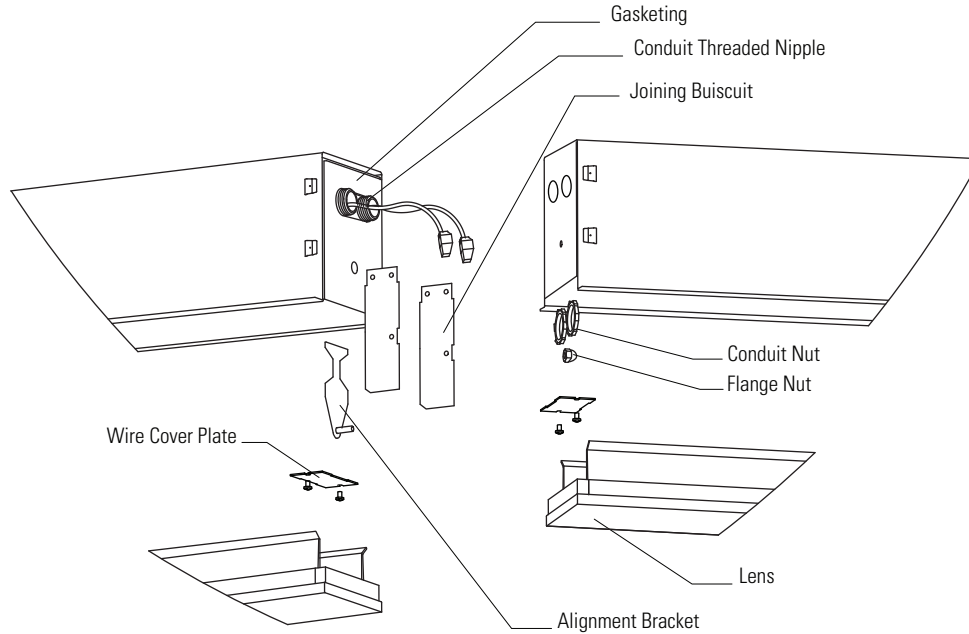

## Optional Step 5:

### End Feed

1. Remove Lens and Wire Cover plates (use flat tool to remove lens).
2. Connect Wet Rated 1/2" conduit to end of fixture.
3. Pull wires through and make necessary wire connections.
4. Reinstall wire cover and lens.

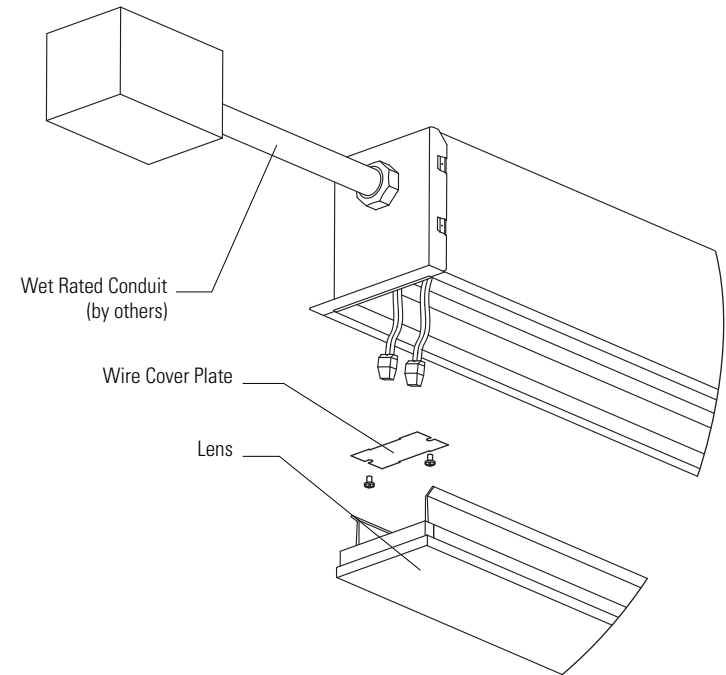

1. This product must be installed in accordance with applicable installation and electrical codes by a professional familiar with the construction and operation of the product.
2. Minimum 90°C supply conductors
3. All electrical connections must be performed by a certified electrician to applicable local and national electrical codes.

4. Fixtures must be mounted directly to structure.
5. The holding strength of AC cables cannot be guaranteed if the cables are damaged in any way.
6. All of Pinnacle's packaging is recyclable with the exception of the straps on the pallets. Please reach out to the factory if you need assistance in recycling any packaging components.

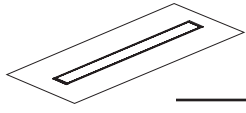

**EDGE**  
EVOLUTION

6 WET

# LED Recessed FL Mount Instructions

*LED Module does not need to be removed for installation*

## EXAMPLE:

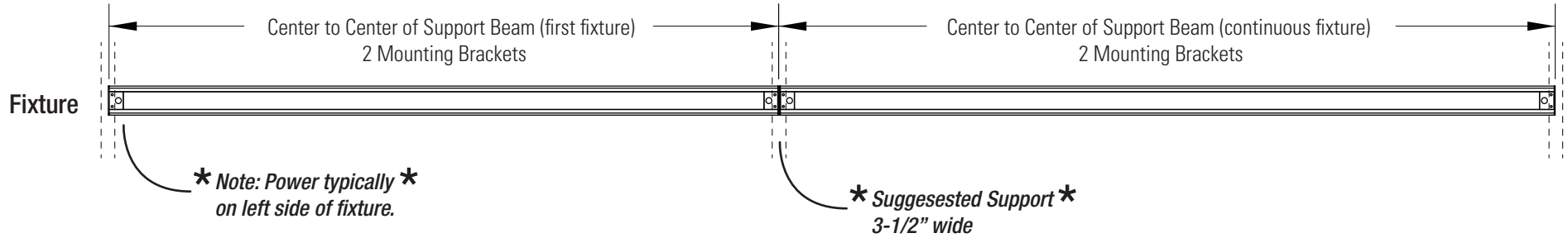

### Mounting Details

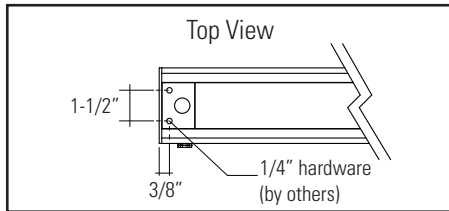

*\* Use one mounting hole at each mount location. \**

### First/ Independent Fixture Mounting Example

2'	27-1/8" center to center of support
3'	39" center to center of support
4'	50-3/4" center to center of support
5'	62-5/8" center to center of support
6'	74-5/8" center to center of support
7'	86-1/2" center to center of support
8'	98-3/8" center to center of support

### Intermediate/ End Fixture Mounting Example

2'	27-1/8" center to center of support
3'	39" center to center of support
4'	50-3/4" center to center of support
5'	62-5/8" center to center of support
6'	74-5/8" center to center of support
7'	86-1/2" center to center of support
8'	98-3/8" center to center of support

*The center to center dimension equals the actual fixture length minus gasket. The support beam should be wide enough to allow for tandem lag screws to attach at fixture joint. The gasket between fixtures in a run adds very little to the overall length due to compression.*



1. This product must be installed in accordance with applicable installation and electrical codes by a professional familiar with the construction and operation of the product.
2. Minimum 90°C supply conductors
3. All electrical connections must be performed by a certified electrician to applicable local and national electrical codes.

4. Fixtures must be mounted directly to structure.
5. The holding strength of AC cables cannot be guaranteed if the cables are damaged in any way.
6. All of Pinnacle's packaging is recyclable with the exception of the straps on the pallets. Please reach out to the factory if you need assistance in recycling any packaging components.



# EDGE Wet

LED  
SURFACE MOUNT INSTALLATION

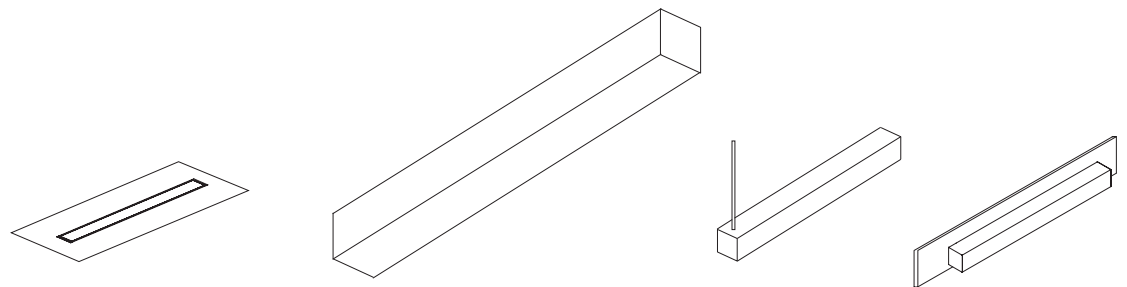

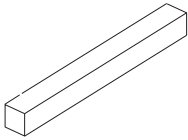

**EDGE**  
EVOLUTION WET

## LED Surface Mount Instructions

*LED Module does not need to be removed for installation. Recommended: Contractor seal top edge of fixture to building surface.*

### Step 1:

#### Fixture Prep

1. Ensure proper support behind fixture (see chart on last page for mounting locations).
2. Using flat thin tool carefully remove Lens so as not to damage lens or fixture.
3. Remove Wire Cover Plate.

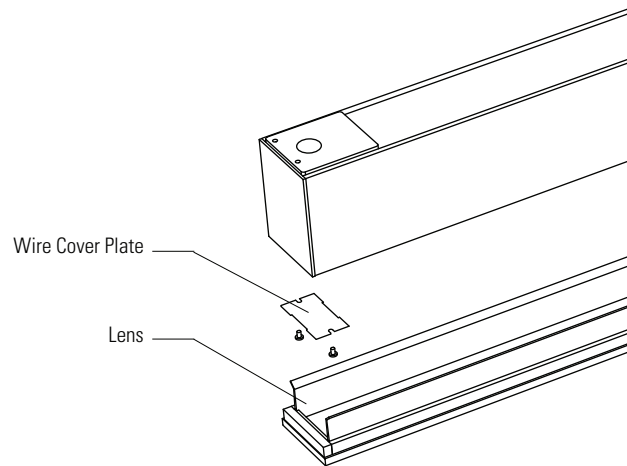

### Step 2:

#### Mounting and Power

1. Install Wet rated Conduit fitting (by others).
2. Install fixture using four (4) mounting screws, two (2) at each end of fixture (screws by others).
3. Make necessary connections between fixture and building power using wet rated flex conduit ensuring all wires are properly matched.
4. Reinstall Wire Cover Plate and lens.

*(Note: If joining fixtures to make a row, all fixtures in row required mounting hardware at both ends of fixture.)*

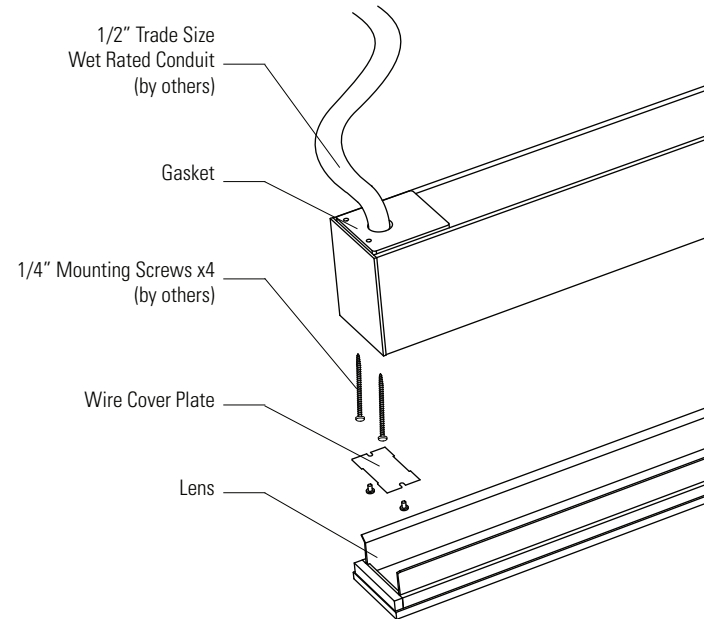

*Fixtures may only be installed with the direct lens facing down. For an in-wall application with the lens facing outward, please see the EDGE Wet Recessed Spec Sheet.*



1. This product must be installed in accordance with applicable installation and electrical codes by a professional familiar with the construction and operation of the product.
2. Minimum 90°C supply conductors
3. All electrical connections must be performed by a certified electrician to applicable local and national electrical codes.

4. Fixtures must be mounted directly to structure.
5. The holding strength of AC cables cannot be guaranteed if the cables are damaged in any way.
6. All of Pinnacle's packaging is recyclable with the exception of the straps on the pallets. Please reach out to the factory if you need assistance in recycling any packaging components.



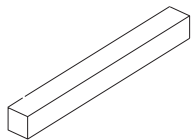

**EDGE**  
EVOLUTION WET

# LED Surface Mount Instructions

*LED Module does not need to be removed for installation. Recommended: Contractor seal top edge of fixture to building surface.*

## Optional Step 3: Connecting Fixtures Together

1. Remove Lens and Wire Cover plates (use flat tool to remove lens).
2. Run wires through the Conduit Nipple and the Conduit Nuts prior to wiring fixtures together.
3. Make necessary wiring connections between fixtures ensuring all wires are properly matched and push back into wire cavity.
4. Slide fixtures together and use alignment bracket and nut to ensure fixtures are lined up perfectly.
5. Tighten the Conduit Nuts and re-install Wire Cover plates.
6. Reinstall the Lens making sure lens is fully engaged.

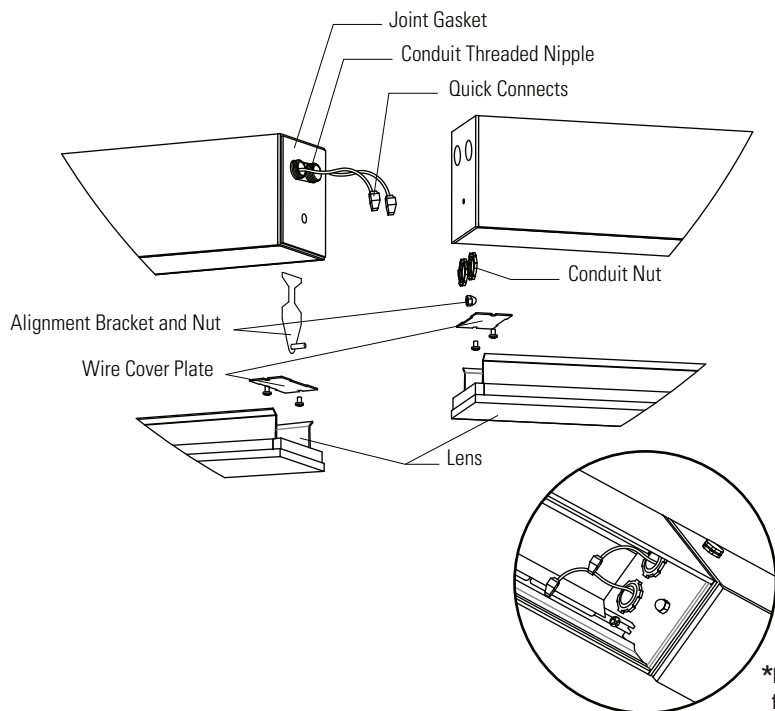

## Optional Step 4: End Feed

1. Remove Lens and Wire Cover plates (use flat tool to remove lens).
2. Connect Wet Rated 1/2" conduit to end of fixture.
3. Pull wires through and make necessary wire connections.
4. Reinstall wire cover and lens.

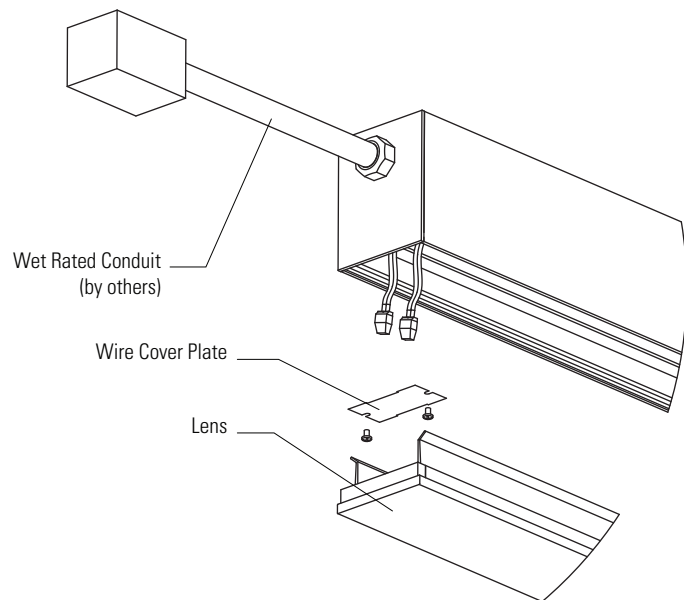

*Fixtures may only be installed with the direct lens facing down. For an in-wall application with the lens facing outward, please see the EDGE Wet Recessed Spec Sheet.*



1. This product must be installed in accordance with applicable installation and electrical codes by a professional familiar with the construction and operation of the product.
2. Minimum 90°C supply conductors
3. All electrical connections must be performed by a certified electrician to applicable local and national electrical codes.

4. Fixtures must be mounted directly to structure.
5. The holding strength of AC cables cannot be guaranteed if the cables are damaged in any way.
6. All of Pinnacle's packaging is recyclable with the exception of the straps on the pallets. Please reach out to the factory if you need assistance in recycling any packaging components.

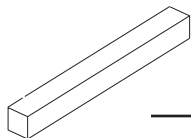

**EDGE**  
EVOLUTION **WET**

## LED Surface Mount Instructions

*LED Module does not need to be removed for installation. Recommended: Contractor seal top edge of fixture to building surface.*

### EXAMPLE:

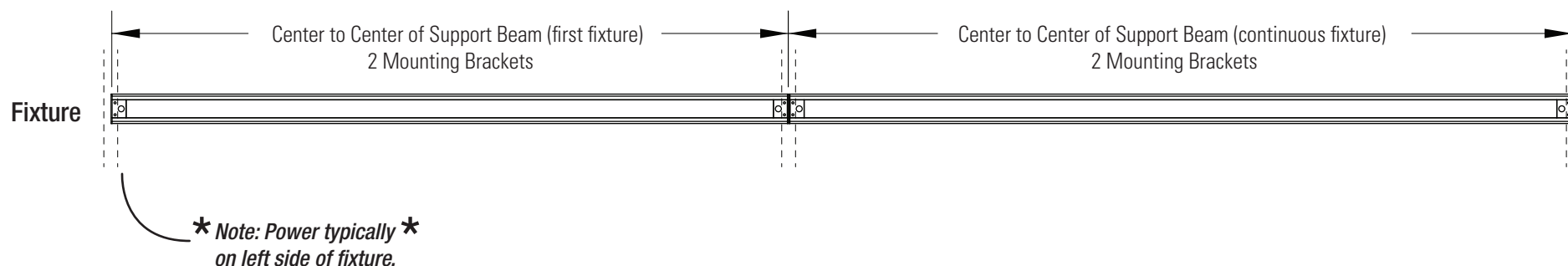

### Mounting Details

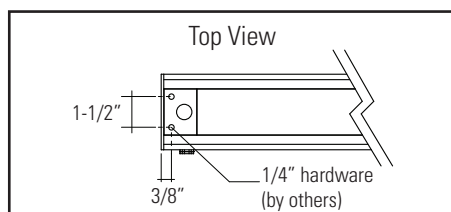

**\*Use both mounting holes at each mount location.\***

### First/ Independent Fixture Mounting Example

2'	27-1/8" center to center of support
3'	39" center to center of support
4'	50-3/4" center to center of support
5'	62-5/8" center to center of support
6'	74-5/8" center to center of support
7'	86-1/2" center to center of support
8'	98-3/8" center to center of support

### Intermediate/ End Fixture Mounting Example

2'	27-1/8" center to center of support
3'	39" center to center of support
4'	50-3/4" center to center of support
5'	62-5/8" center to center of support
6'	74-5/8" center to center of support
7'	86-1/2" center to center of support
8'	98-3/8" center to center of support

*Fixtures may only be installed with the direct lens facing down. For an in-wall application with the lens facing outward, please see the EDGE Wet Recessed Spec Sheet.*



1. This product must be installed in accordance with applicable installation and electrical codes by a professional familiar with the construction and operation of the product.
2. Minimum 90°C supply conductors
3. All electrical connections must be performed by a certified electrician to applicable local and national electrical codes.

4. Fixtures must be mounted directly to structure.
5. The holding strength of AC cables cannot be guaranteed if the cables are damaged in any way.
6. All of Pinnacle's packaging is recyclable with the exception of the straps on the pallets. Please reach out to the factory if you need assistance in recycling any packaging components.



# EDGE Wet

LED  
PENDANT MOUNT INSTALLATION

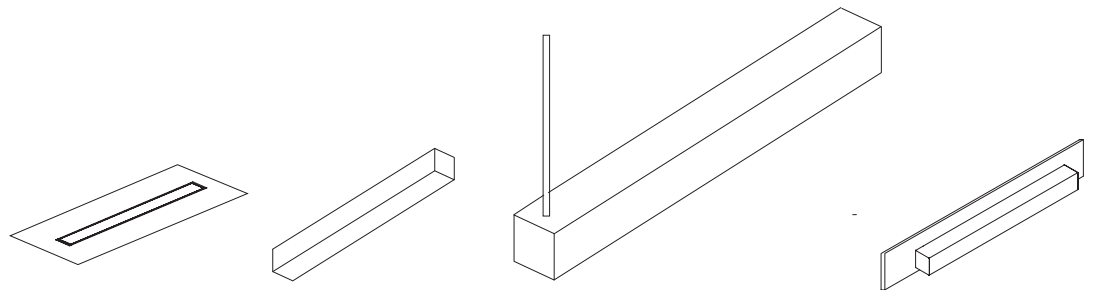

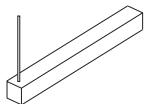

**EDGE**  
EVOLUTION WET

# LED Pendant Mount Instructions

*LED Module does not need to be removed for installation*

## Step 1: Power Mount

1. Install 4-Octagonal Junction boxes to structure at all mounting locations.
2. Install conduit from building power to J-Box.
3. Install crossbar to J-Box.
4. Remove Lens and Wire Cover Plates from fixture. (see back page for opening the lens)
5. Feed slip canopy over pendant and secure pendant to crossbar.
6. Attach Pendant Nut and Gasket Washer to top end of pendant, Teflon Tape the pendant threads, and feed pendant through fixture hole and attach second Conduit Nut inside of fixture.
7. Feed power wired through pendant and out leaving 12" for wiring.
8. Make necessary connections between fixture and building wires.

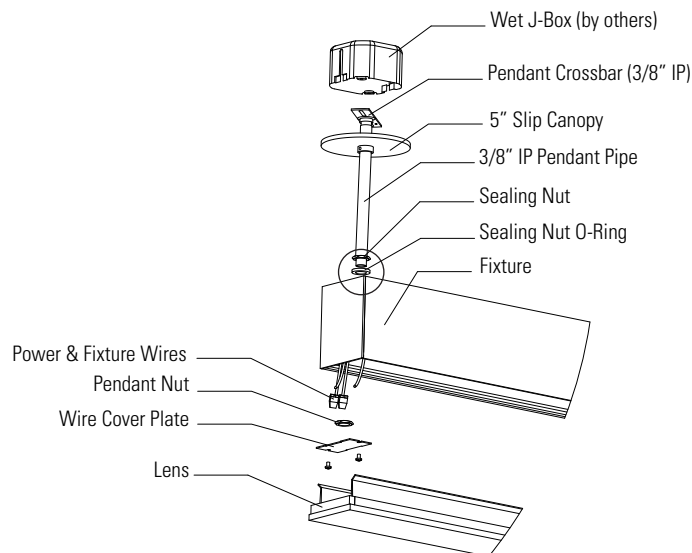

## Step 2: Non Power Mount

1. Install 4-Octagonal Junction boxes to structure at all mounting locations.
2. Install conduit from building power to J-Box.
3. Install crossbar to J-Box.
4. Feed slip canopy over pendant and secure pendant to crossbar.
5. Attach Pendant Nut and Gasket Washer to top end of pendant, teflon tape the pendant threads, and feed pendant through fixture hole and attach second Conduit Nut inside of fixture.
6. Reinstall Wire Cover Plates and Lens.

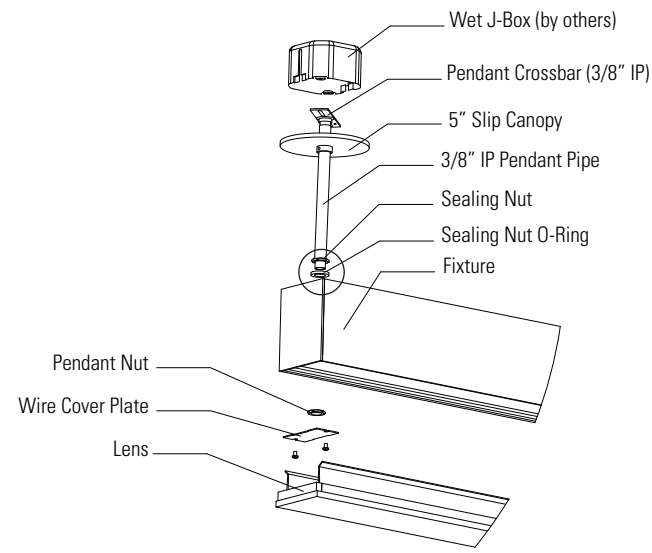

**\* This applies to both  
Power and Non Power  
mounting locations**



1. This product must be installed in accordance with applicable installation and electrical codes by a professional familiar with the construction and operation of the product.
2. Minimum 90°C supply conductors
3. All electrical connections must be performed by a certified electrician to applicable local and national electrical codes.

4. Fixtures must be mounted directly to structure.
5. The holding strength of AC cables cannot be guaranteed if the cables are damaged in any way.
6. All of Pinnacle's packaging is recyclable with the exception of the straps on the pallets. Please reach out to the factory if you need assistance in recycling any packaging components.

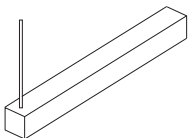

**EDGE**  
EVOLUTION

**WET**

# LED Pendant Mount Instructions

*LED Module does not need to be removed for installation*

## Optional Step 3: Connecting Fixtures Together

1. Remove Lenses and Wire Cover plates (use flat tool to remove lens).
2. Run wires through the Conduit Nipple and the Conduit Nuts prior to wiring fixtures together.
3. Make necessary wiring connections between fixtures ensuring all wires are properly matched.
4. Slide fixtures together, use Joining Biscuits to align fixtures.
5. Install Alignment Bracket, use to hold Conduit Nipples while tightening fixtures together.
6. Reinstall Wire Cover Plates and Lenses.

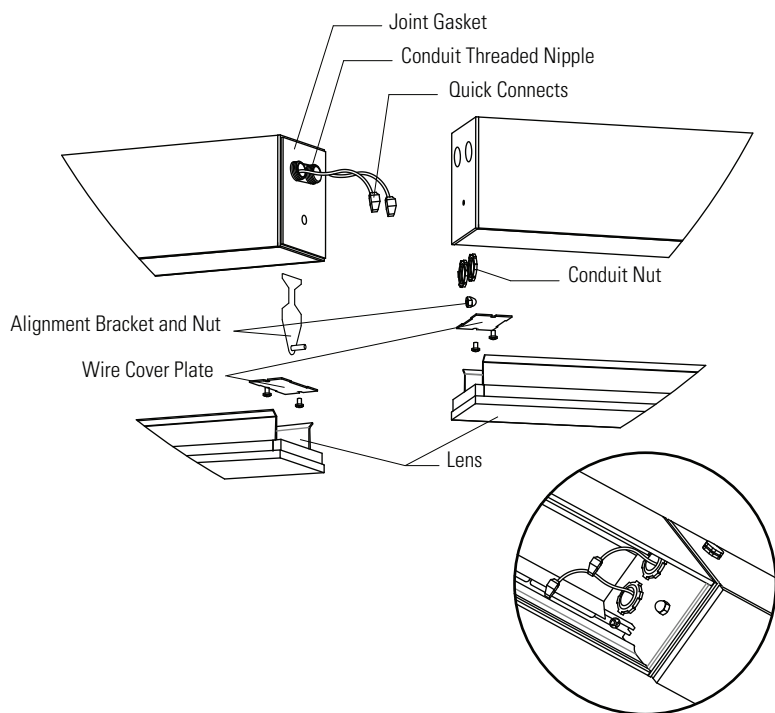

## Optional Step 5: End Feed

1. Remove Lens and Wire Cover plates (use flat tool to remove lens).
2. Connect Wet Rated 1/2" conduit to end of fixture.
3. Pull wires through and make necessary wire connections.
4. Reinstall wire cover and lens.

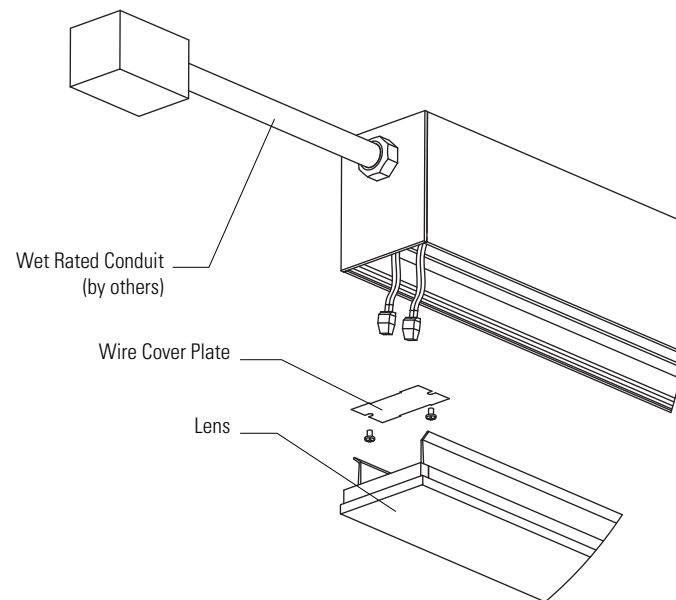

1. This product must be installed in accordance with applicable installation and electrical codes by a professional familiar with the construction and operation of the product.
2. Minimum 90°C supply conductors
3. All electrical connections must be performed by a certified electrician to applicable local and national electrical codes.

4. Fixtures must be mounted directly to structure.
5. The holding strength of AC cables cannot be guaranteed if the cables are damaged in any way.
6. All of Pinnacle's packaging is recyclable with the exception of the straps on the pallets. Please reach out to the factory if you need assistance in recycling any packaging components.



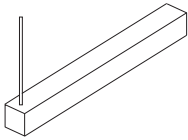

**EDGE**  
EVOLUTION **WET**

# LED Pendant Mount Instructions

*LED Module does not need to be removed for installation*

## EXAMPLE:

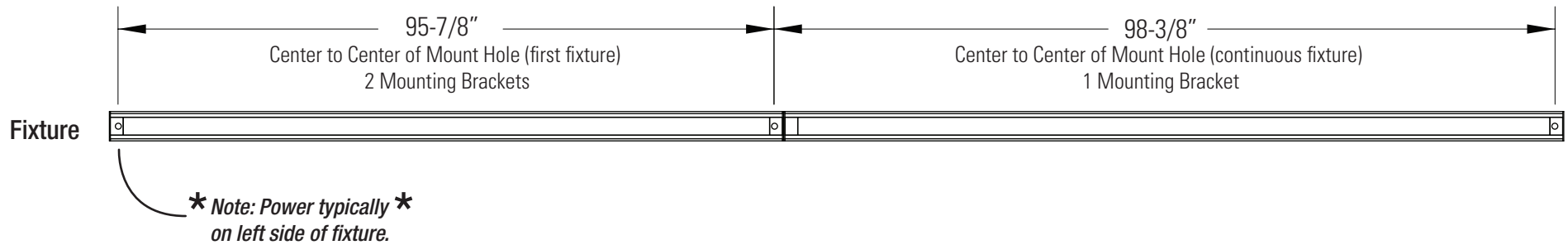

## Mounting Details

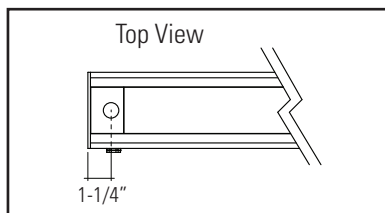

### First/ Independent Fixture Mounting Example

2'	24-5/8" center to center of mounting hole
3'	36-1/2" center to center of mounting hole
4'	48-1/4" center to center of mounting hole
5'	60-1/8" center to center of mounting hole
6'	72-1/8" center to center of mounting hole
7'	84" center to center of mounting hole
8'	95-7/8" center to center of mounting hole

### Intermediate/ End Fixture Mounting Example

2'	27-1/8" center to center of mounting hole
3'	39" center to center of mounting hole
4'	50-7/8" center to center of mounting hole
5'	62-3/4" center to center of mounting hole
6'	74-5/8" center to center of mounting hole
7'	86-1/2" center to center of mounting hole
8'	98-3/8" center to center of mounting hole



1. This product must be installed in accordance with applicable installation and electrical codes by a professional familiar with the construction and operation of the product.
2. Minimum 90°C supply conductors
3. All electrical connections must be performed by a certified electrician to applicable local and national electrical codes.

4. Fixtures must be mounted directly to structure.
5. The holding strength of AC cables cannot be guaranteed if the cables are damaged in any way.
6. All of Pinnacle's packaging is recyclable with the exception of the straps on the pallets. Please reach out to the factory if you need assistance in recycling any packaging components.



# EDGE Wet

LED  
WALL MOUNT INSTALLATION

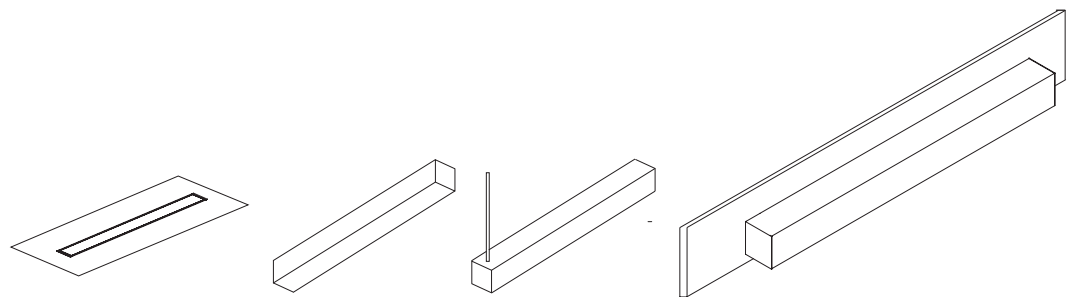

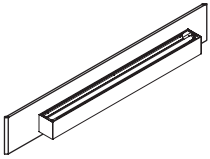

*LED Module does not need to be removed for installation*

## Step 1: Wall Bracket

1. Attach wall side bracket to structure via mounting hardware (by others).
2. If power side, mount bracket in line with 2x4 junction box (by others).
3. Bring power in through junction box.
4. Follow mount spacing on page 3 for additional mounting points.

**(Note: Powerside fixture bracket will have gasket.)**

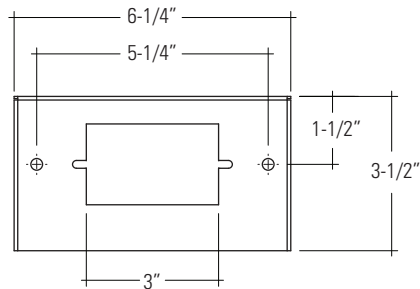
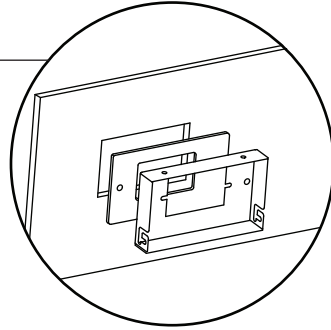

## Step 2: Power Mount

1. Place fixture in wiring position by lifting fixture into place and having Pem on wall side bracket slide into Pem Channel on fixture side bracket, once in fixture can swing down to allow for hands free wiring.
2. To power fixture, attach building power to fixture power wires using push nuts.
3. Recess connections into junction box. Making sure no wires are between bracket and gasket.
4. Make necessary adjustments laterally prior to tightening wall mount screw.

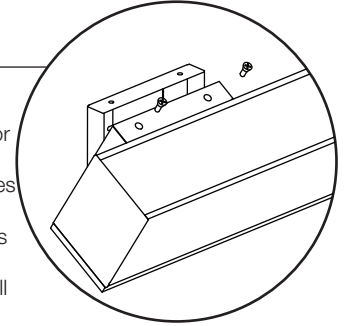

**\* hands free \*  
wiring position**

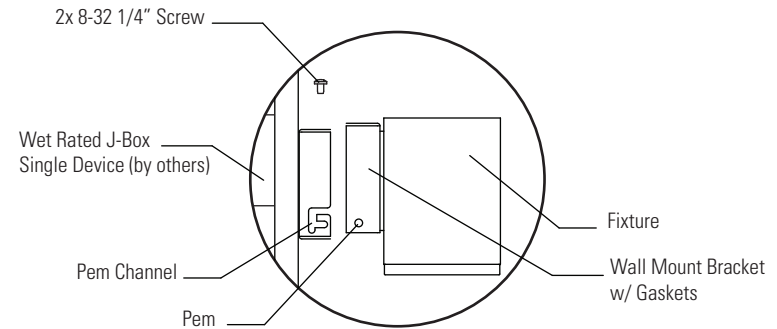

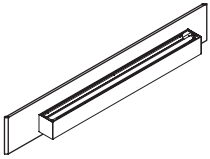

**EDGE**  
EVOLUTION

**WET**

# LED Wall Mount Instructions

*LED Module does not need to be removed for installation*

## Optional Step 3:

### Connecting Fixtures Together

1. Remove Lens and Wire Cover plates (use flat tool to remove lens).
2. Run wires through the Conduit Nipple and the Conduit Nuts prior to wiring fixtures together.
3. Make necessary wiring connections between fixtures ensuring all wires are properly matched and push back into wire cavity.
4. Slide fixtures together and use alignment bracket and nut to ensure fixtures are lined up perfectly.
5. Tighten the Conduit Nuts and re-install Wire Cover plates.
6. Reinstall the Lens making sure lens is fully engaged.

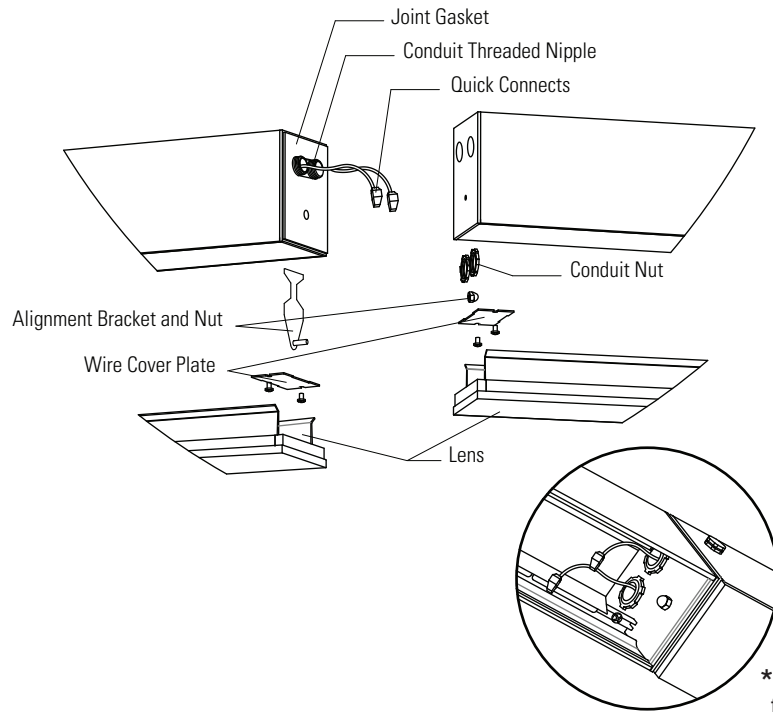

\*LED Module removed for clarity

## Optional Step 4:

### End Feed

1. Remove Lens and Wire Cover plates (use flat tool to remove lens).
2. Connect Wet Rated 1/2" conduit to end of fixture.
3. Pull wires through and make necessary wire connections.
4. Reinstall wire cover and lens.

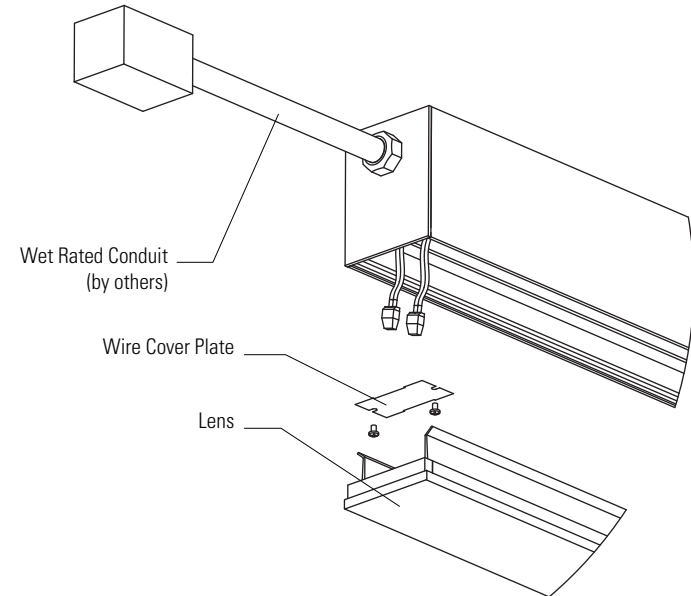

**DO NOT apply force to the end of Lens!**



1. This product must be installed in accordance with applicable installation and electrical codes by a professional familiar with the construction and operation of the product.
2. Minimum 90°C supply conductors
3. All electrical connections must be performed by a certified electrician to applicable local and national electrical codes.

4. Fixtures must be mounted directly to structure.
5. The holding strength of AC cables cannot be guaranteed if the cables are damaged in any way.
6. All of Pinnacle's packaging is recyclable with the exception of the straps on the pallets. Please reach out to the factory if you need assistance in recycling any packaging components.

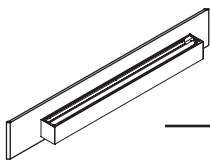

**EXAMPLE:**

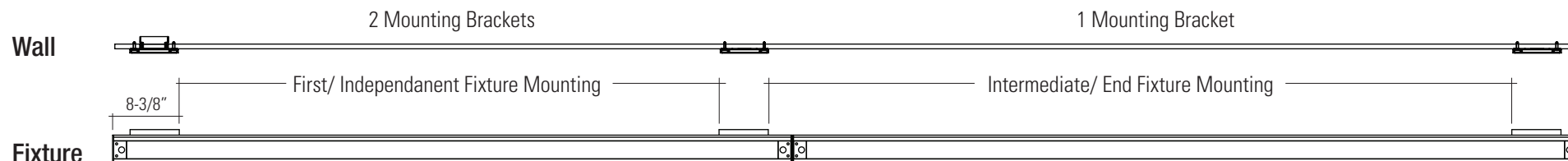

**Mounting Bracket Details**

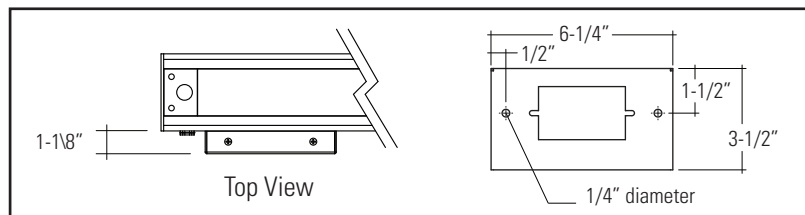

**First/ Independent Fixture Mounting**

2'	10-3/8" edge to edge of bracket
3'	22-1/4" edge to edge of bracket
4'	34-1/4" edge to edge of bracket
5'	46-1/8" edge to edge of bracket
6'	57-7/8" edge to edge of bracket
7'	69-3/4" edge to edge of bracket
8'	81-5/8" edge to edge of bracket

**Intermediate/ End Fixture Mounting**

2'	20-7/8" edge to edge of bracket
3'	32-3/4" edge to edge of bracket
4'	44-3/4" edge to edge of bracket
5'	56-5/8" edge to edge of bracket
6'	68-3/8" edge to edge of bracket
7'	80-1/4" edge to edge of bracket
8'	92-1/8" edge to edge of bracket

**\* Note: Power typically \***  
**on left side of fixture.**





EDGE Wet LENS  
DETAIL

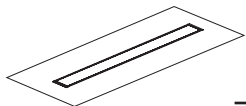

## Lens Installation

1. Begin at one end of the lens and squeeze sides to allow it to flex.
2. Insert end of lens into place. Lens will snap into place when installed properly.
3. Slowly insert rest of lens down the length of the fixture

## Lens Removal

1. Insert a rigid object approx. Such as a putty knife, into the edge between the lens and the fixture side about one inch from end.
2. Using said object, gently pry lens away from fixture until it is released from the mounting edge.
3. Once the section is released, start at that end of the fixture and pull the lens out of the fixture.

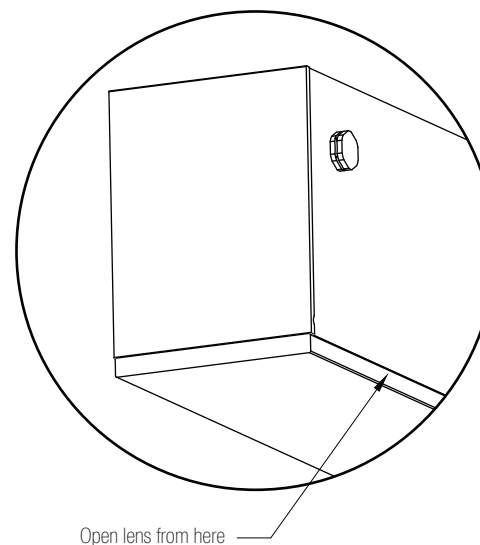
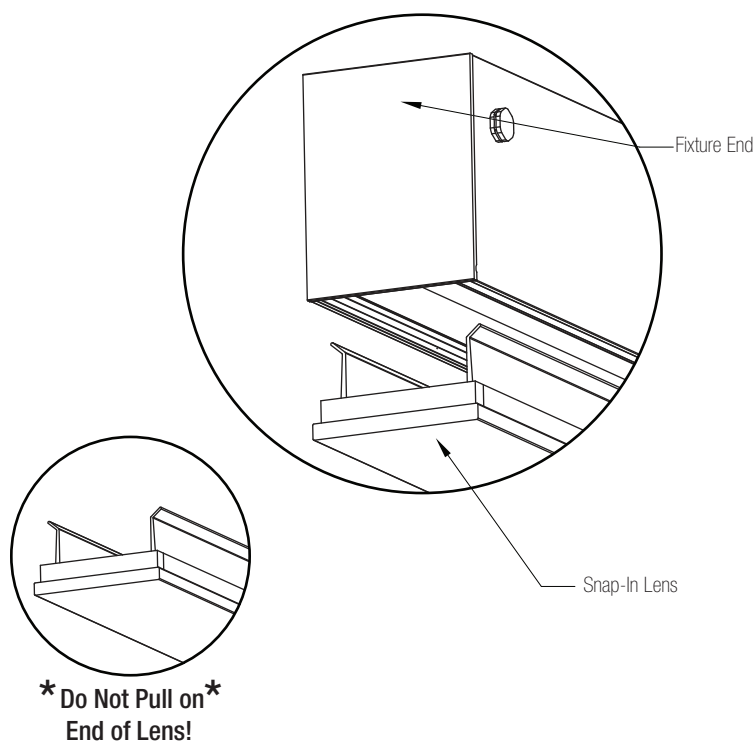

**Note: Low temperatures can effect the lens material, making it brittle. Please allow the lenses to warm to room temperature before installation.**