

FINA F14D

14" Direct Recessed Architectural Round

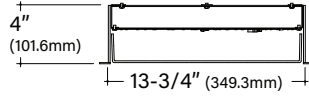

Key Features

- Extruded aluminum housing is rolled and welded for seamless finish with 3/4" trim
- Aluminum top cover conceals all electrical components. Highly reflective die-formed white painted steel reflector
- FINA offered with a 5-year limited warranty. Covers LED, driver and fixture
- ETL Listed conforming to UL1598 in US and CSA 250 in Canada
- Maximum fixture weight is 15 lbs
- Room-side maintenance for LED system
- Buy American Act compliant



Example Part #: F14D-A-830HO-G-U-PL2-1-0-W

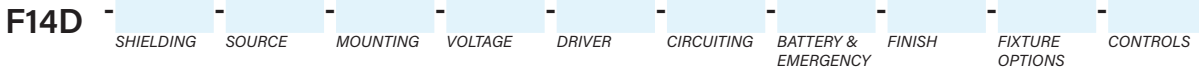

| SHIELDING | SOURCE ¹ | MOUNTING | VOLTAGE |
|--|--|--|---|
| A - Flush Satine Lens AL - Drop Satine Lens AR - Regress Satine Lens <i>Shielding pg. 2</i> | 27 - 2700K 30 - 3000K 35 - 3500K 40 - 4000K CL - Custom Lumens CW - Custom Watts <i>Source pg. 2</i> | G - Grid Ceiling FL - Flanged NF - Non-Flanged SF - Spackle Flange <i>Mounting pg. 3</i> | U - Universal (120 thru 277V) 1 - 120V 2 - 277V 3 - 347V <i>Voltage pg. 3</i> |
| DRIVER | CIRCUITING | BATTERY & EMERGENCY | FINISH |
| PL2 - Advance Xitanium (1%, 0-10v) EE1 - eldoLED ECOdrive (1%, 0-10v) ES1 - eldoLED SOLOdrive (0%, 0-10v) LH1 - Lutron Hi-lume (1%, EcoSystem) L51 - Lutron 5-Series (5%, EcoSystem) OL2 - Osram Optotronic (1%, 0-10v) OL4 - Osram Optotronic 347v (1%, 0-10v) ND - Non-Dimming <i>Driver pg. 3</i> | 1 - Single Circuit E - Emergency (entire fixture) N - Night Light (entire fixture) <i>Circuiting pg. 4</i> | 0 - None 1PRL - Bodine 7W Remote <i>Battery and Emergency pg. 4</i> | W - White <i>Finish pg. 4</i> |
| FIXTURE OPTIONS | CONTROLS ² | | |
| CP - Chicago Plenum AM - Antimicrobial Paint FW6 - 6' Flex Whip GMF - Slow Blow Fusing <i>Fixture Options pg. 4</i> | DLMFC - Wattstopper DLM (wired) ENLI - Enlighted IOT (remote) ENLC - Enlighted Connected Lighting (remote) <i>Controls pg. 4</i> | | |

¹When specifying SOURCE the first _ is for specifying either **8** - 80CRI, **9** - 90CRI. The ending _ _ are for specifying output, example **HO** - High Output. See output charts for more information. ²Controls can only be used with Single Circuit (1) or Emergency Circuit (E), cannot be used with any battery options. See Controls chart on page 4 for driver options and more information.

Specifications and dimensions subject to change without notice. Specification sheets that appear on pinnacle-ltg.com are the most recent version and supersede all other previously printed or electronic versions.



Shielding

- White virgin acrylic lens with matte finish, removable for LED access
- Lens available in 3 positions

Ordering Code

| A | AL | AR |
|-------------------|------------------|---------------------|
| Flush Satine Lens | Drop Satine Lens | Regress Satine Lens |
| | | |

Source: White LED

- Specify either 80 or 90 CRI
- Longer lead-time may apply for 90 CRI. Consult factory
- 80 CRI = R9≥19 and 90 CRI = R9≥61

Custom Output- Lumens OR Wattage

| | | |
|-----------------|--|--|
| CL _____ | Specify CRI, CCT and desired lumens (i.e. CL8352000) | Specify lumens between standard offering listed below. Lumens are specified per color temp |
| CW _____ | Specify CRI, CCT and desired wattage (i.e. CW94020) | Specify watts between standard offering listed below |

80 CRI

| | Color | Shielding | | |
|--------------|-------|-----------------------|-------|-----|
| | | A, AL, AR Satine Lens | | |
| | | Lumens | Watts | LPW |
| 830LO | 3000K | 838 | 9.0 | 93 |
| 830MO | 3000K | 1438 | 14.3 | 101 |
| 830HO | 3000K | 2015 | 19.6 | 103 |
| 835LO | 3500K | 895 | 9.1 | 98 |
| 835MO | 3500K | 1534 | 14.4 | 107 |
| 835HO | 3500K | 2150 | 19.7 | 109 |
| 840LO | 4000K | 904 | 9.1 | 100 |
| 840MO | 4000K | 1548 | 14.3 | 108 |
| 840HO | 4000K | 2169 | 19.6 | 111 |

90 CRI

| | | | | |
|--------------|-------|------|------|----|
| 927LO | 2700K | 701 | 9.4 | 75 |
| 927MO | 2700K | 1179 | 15.0 | 79 |
| 927HO | 2700K | 1624 | 20.8 | 78 |
| 930LO | 3000K | 725 | 9.3 | 78 |
| 930MO | 3000K | 1226 | 14.8 | 83 |
| 930HO | 3000K | 1692 | 20.6 | 82 |
| 935LO | 3500K | 725 | 9.3 | 78 |
| 935MO | 3500K | 1226 | 14.8 | 83 |
| 935HO | 3500K | 1692 | 20.6 | 82 |
| 940LO | 4000K | 768 | 9.3 | 82 |
| 940MO | 4000K | 1300 | 15.0 | 87 |
| 940HO | 4000K | 1795 | 20.8 | 86 |



Mounting

- Designed to install into acoustical grid and inaccessible ceilings
- Tie off fixture to structure with retention wires
- Maximum fixture weight is 15 lbs

G

Grid Ceiling with 3/4" (19.1mm) Trim
15/16" T-Bar

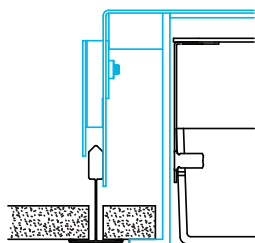

9/16" T-Bar

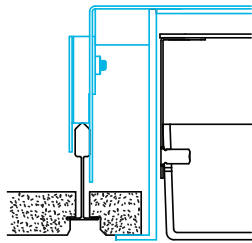

Screw Slot T-Bar

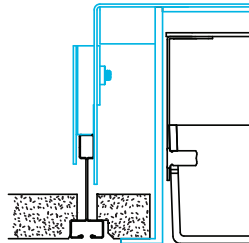

Recessed box allows for 1/2" of adjustability to accommodate a variety of grid ceilings

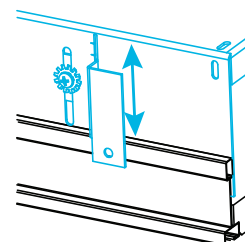

FL

Standard 3/4" (19.1mm) Flange
Exposed Flange

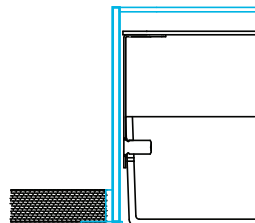

NF

Non-Flange with 1/4" (6.4mm) Trim
Metal Pan or Millwork

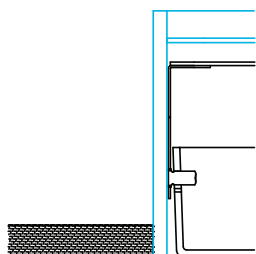

SF

Spackle Flange
Drywall, Flangeless

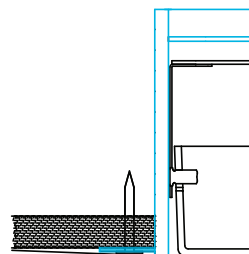

Voltage

- Some FINA configurations will not accommodate all voltage options; consult with factory

| | |
|----------|-----------|
| U | Universal |
| 1 | 120 volt |
| 2 | 277 volt |
| 3 | 347 volt |

Driver

- Standard Driver Option = PL2
- Driver Lifetime: 50,000 hours at 25°C ambient operating conditions
- For more Driver options, see Pinnacle Resource Guide on download pages at pinnacle-ltg.com
- Some FINA configurations will not accommodate all driver options; consult with factory

| | |
|------------|---|
| PL2 | Philips Advance Xitanium 1%, 0-10v |
| EE1 | eldoLED ECOdrive 1%, 0-10v Logarithmic |
| EE2 | eldoLED ECOdrive 1%, 0-10v Linear |
| ES1 | eldoLED SOLOdrive 0%, 0-10v Logarithmic |
| ES2 | eldoLED SOLOdrive 0%, 0-10v Linear |
| LH1 | Lutron Hi-lume Soft-on, Fade-to-black 1%, EcoSystem, LDE1 |
| L51 | Lutron 5-Series 5%, EcoSystem, LDE5 |
| OL2 | Osram Optotronic 1%, 0-10v, nominal 1% dimming range |
| OL4 | Osram Optotronic 347v 1%, 0-10v, requires 347v option |
| ND | Non-Dimming |

Specifications and dimensions subject to change without notice. Specification sheets that appear on pinnacle-ltg.com are the most recent version and supersede all other previously printed or electronic versions.

Designed in Denver, CO • USA | pinnacle-ltg.com | O: 303-322-5570 F: 303-322-5568

F14D_RECESS_SPEC_NOV2020



Circuiting

- Select fixture circuiting from options below
- Some FINA configurations will not accommodate all circuiting options; consult with factory

| | |
|----------|--------------------------|
| 1 | Single Circuit |
| E | Emergency Circuit only |
| N | Night Light Circuit only |

Battery & Emergency

- Select battery or emergency options if required
- Battery duration is 90 minutes
- Test button is remote to fixture

- For more Battery options, see Pinnacle Resource Guide on download pages at pinnacle-ltg.com

| | |
|-------------|------------------|
| 0 | No Battery |
| 1PRL | Bodine 7w Remote |

For Approximate Battery Lumen Output

- Multiply battery wattage X fixture LPW shown on Lumen Table
- 10 (watts) x 92.3 (LPW) = 923 battery lumen output

Battery & Emergency Ordering Examples

- Single circuit, 10w integral battery Ordering Code: 1-1P
- Emergency circuit only, 10w integral battery Ordering Code: E-1P

Finish

- Powder-coat white painted finish on exposed trim

| | |
|----------|-------|
| W | White |
|----------|-------|

Fixture Options

- Additional options to enhance the fixture and finish of the product

| | |
|------------|-------------------------|
| CP | Chicago Plenum |
| AM | Antimicrobial Paint |
| FW6 | Flex Whip 6' |
| GMF | Internal Slow Blow Fuse |

Controls

- Pinnacle Lighting offers easy to specify network control solutions that connect to an intelligent centralized system to maximize lighting energy efficiencies or integral sensors for individual fixture control
- Pinnacle Lighting fixtures ship technology ready; commissioning by others
- Controls can only be used with Single Circuit (1) or Emergency Circuit (E)
- Contact factory for any non-standard configurations for layout, placement, or EM options
- One sensor per housing typical, contact factory for more information

| | Solution | Components | Network/Sensor | Connection | RQD Drivers | Limitation |
|--------------|------------------------------|------------|-----------------------------------|-----------------------|-------------|-----------------------------|
| DLMFC | Legrand Wattstopper DLM | LMFC-011 | Digital Lighting Management (DLM) | Wired, two RJ45 ports | Any 0-10v | None |
| ENLI | Enlighted IOT | CU-4E | Enlighted, Remote | Enlighted Cable | Any 0-10v | Not available with 347 volt |
| ENLC | Enlighted Connected Lightign | CU-4E | Enlighted, Remote | Enlighted Cable | Any 0-10v | Not available with 347 volt |



Photometrics

Satine Lens

| | |
|-----------|---------------|
| Test # | ITL92428 |
| Catalog # | F14D-AL-840HO |
| Lumens | 2226 lm |
| Watts | 19.6 W |
| Efficacy | 1174 LPW |

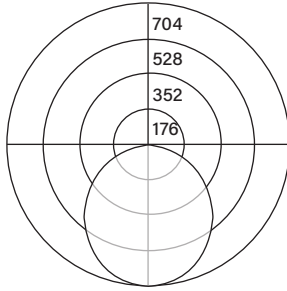

Candela Distribution

| Vert Angle | Horizontal Angle |
|------------|------------------|
| 0 | 0 |
| 5 | 700 |
| 10 | 696 |
| 15 | 680 |
| 20 | 659 |
| 25 | 632 |
| 30 | 601 |
| 35 | 566 |
| 40 | 526 |
| 45 | 483 |
| 50 | 436 |
| 55 | 386 |
| 60 | 333 |
| 65 | 278 |
| 70 | 221 |
| 75 | 164 |
| 80 | 111 |
| 85 | 67 |
| 90 | 36 |
| 95 | 31 |
| 100 | 26 |
| 105 | 22 |
| 110 | 18 |
| 115 | 14 |
| 120 | 10 |
| 125 | 7 |
| 130 | 4 |
| 135 | 2 |

Luminance Data (cd/sq.m)

| Angle In Degrees | Average 0-Deg | Average 45-Deg | Average 90-Deg |
|------------------|---------------|----------------|----------------|
| 45 | 7288 | 7288 | 7288 |
| 55 | 6978 | 6978 | 6978 |
| 65 | 6513 | 6513 | 6513 |
| 75 | 5704 | 5704 | 5704 |
| 85 | 4804 | 4804 | 4804 |

For all available IES files, please visit our website at pinnacle-ltg.com. Photometry testing in accordance to IESNA-LM-79-08 at an NVLAP accredited testing laboratory. Testing conducted at 25°C ambient conditions

Approvals & Certifications

Construction: Extruded aluminum housing is rolled and welded for seamless finish with minimal trim detail. Aluminum top cover conceals all electrical components. Highly reflective die-formed white painted steel reflector. Wiring access on both sides and top of housing.

Shielding: Single piece diffuse lens creating a fully luminous housing. Available with standard satine lens.

Mounting: Designed to install into acoustical grid and inaccessible ceilings. Recessed, aircraft cable, pendant and surface mount available. For recessed, specify G for acoustical grid ceiling. Specify FL, NF, or SF for inaccessible ceilings. Tie off fixture to structure with retention wires. Maximum fixture weight is 15 lbs.

LED: 25°C test environment. Lumen output/wattage has a margin of +/- 5%. All luminaire configurations tested in accordance with IES LM-79. Diodes tested in accordance with IES LM-80. Lifetime calculated using IES TM-21. Minimum lifetime greater than 60,000 hours. L70 = 146,500 hours and L90 = 45,000 hours. MacAdam 3-Step Ellipses. Not all products are Lighting Facts listed. For all available IES files, please visit our website at pinnacle-ltg.com.

CRI, CCT & Output: Three lumen packages available. Low (LO), Mid (MO) and High (HO). Custom outputs are available. Specify custom lumens or watts between standard offering listed on CRI, CCT & Output page. 80 CRI is available for 3000K, 3500K, and 4000K. 90 CRI is available for 2700K, 3000K, 3500K, and 4000K. 80 CRI = R9≥19 and 90 CRI = R9≥61.

Voltage: Universal (U), 120 volt (1), 277 volt (2), and 347 volt (3) options available. Some FINA configurations will not accommodate all voltage options; consult with factory.

Driver: Standard Driver Option is Advance 0-10V, 1% = PL2. Electronic driver, Power factor is >0.9 with a THD <20%. Driver Lifetime: 50,000 hours at 25°C ambient operating conditions. For more driver options, see Pinnacle Resource Guide on download pages at

pinnacle-ltg.com. Some FINA configurations will not accommodate all driver options.

Circuiting: Select from Single circuit (1), Emergency circuit (E) or Night Light circuit (N). Some FINA configurations will not accommodate all circuiting options, consult with factory.

Battery & Emergency: Select battery or emergency options if required. If battery or emergency option is not required, enter 0. Battery duration is 90 minutes as standard. Test button is remote to fixture. For more Battery options, see Pinnacle Resource Guide on download pages at pinnacle-ltg.com.

Finish: Standard powder-coat textured white. Contact factory for additional custom color and finish options.

Controls: DLM utilizes wired network connections for digital control through switching and dimming with 0-10v LED drivers. Enlighted Smart Sensor provides multi-functionality including daylight harvesting and PIR occupancy; for IOT platform using 0-10v LED drivers. Enlighted Smart Sensor provides multi-functionality including daylight harvesting and PIR occupancy; for Connected platform using 0-10v LED drivers.

Labels: ETL Listed conforming to UL1598 in US and CSA 250 in Canada. Standard and High output lumen packages are IC Rated for recessed fixtures and are approved for dry/damp location unless otherwise noted.

Fixture Weight: 15 lbs maximum

Buy American Act compliant

Warranty: FINA LED offered with a 5-year limited warranty. Covers LED, driver and fixture.