

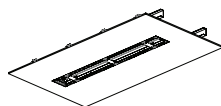

# EDGE Evolution6 **INSTALLATION INSTRUCTIONS**

T5/T5HO, 8 & LED Grid Installation .....	2-5
T5/T5HO, 8 & LED FL-Inaccessible Installation .....	6-9
T5/T5HO, 8 & LED NF-Inaccessible Installation .....	10-13
T5/T5HO, 8 & LED Spackle Flange Mounting .....	14-17
T5/T5HO Staggered Fixture Row Layout .....	18-20
T8 Staggered Fixture Row Layout .....	21-23
2 Lamp Staggered Fixture Row Layout .....	24-26
Lens Detail .....	27-28

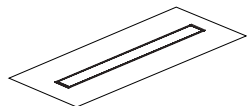

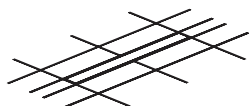

# EDGE Evolution6

T5/T5HO, T8 & LED  
GRID CEILING INSTALLATION

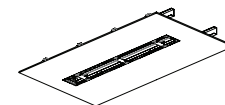
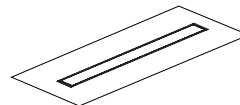
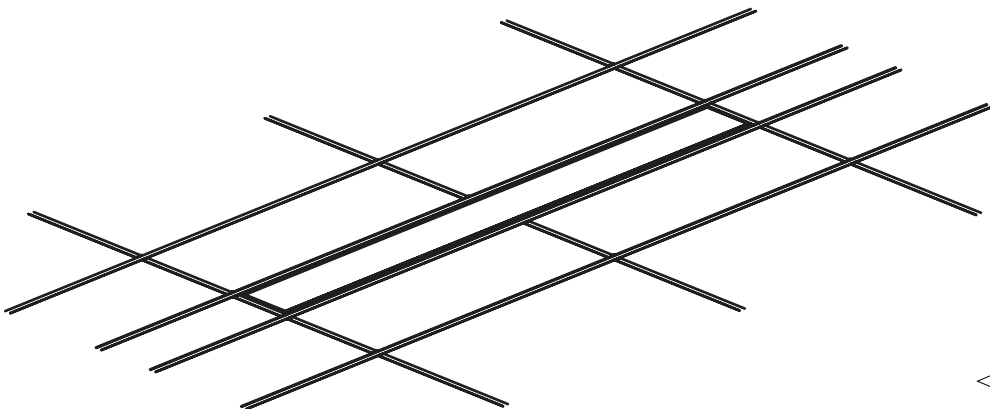

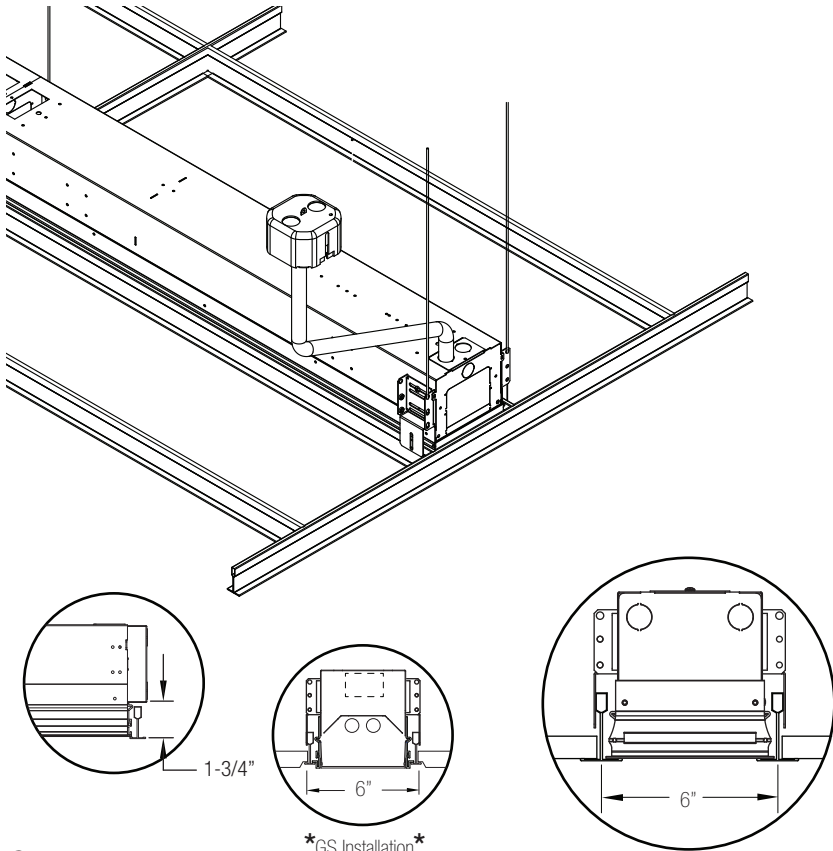
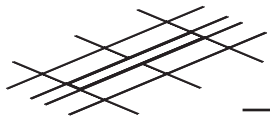

## Step 1: Layout/ Dimensions

1. Layout fixture and T-bar locations, fixtures require secondary mains along the length of the row, both sides.
2. Layout and install junction boxes.
3. Lay first fixture into grid. (note fixture extension, T8 Only)
4. Tie off fixture to structure.

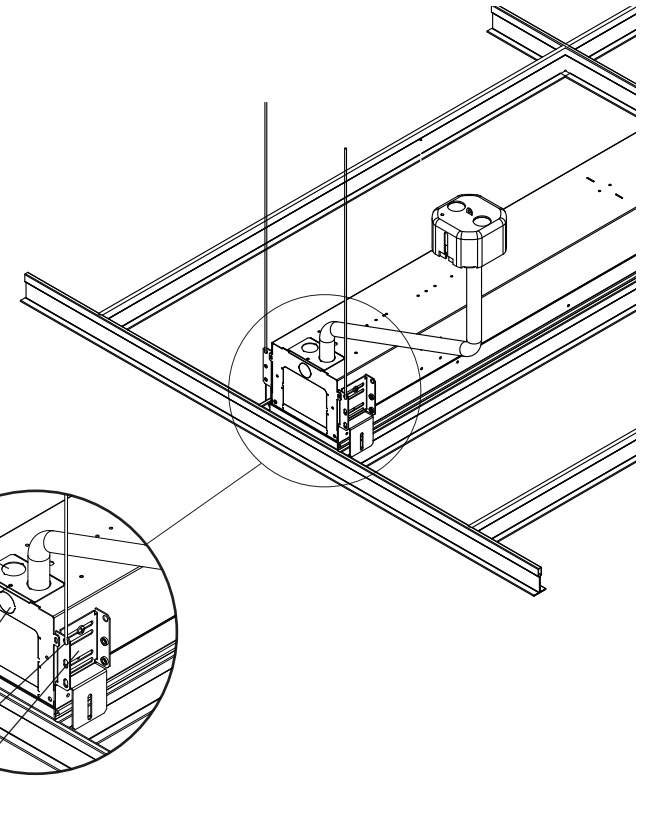

## Step 2: Making the connections

1. Remove applicable access cover.
2. Attach conduit to access cover using 1/2" trade fitting.
3. Make electrical connections inside fixture.
4. Replace access cover.

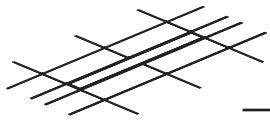

**EDGE**  
EVOLUTION 6

# T5/ T5HO/ T8 & LED Grid Ceiling Installation

[Return to  
Main Menu](#)

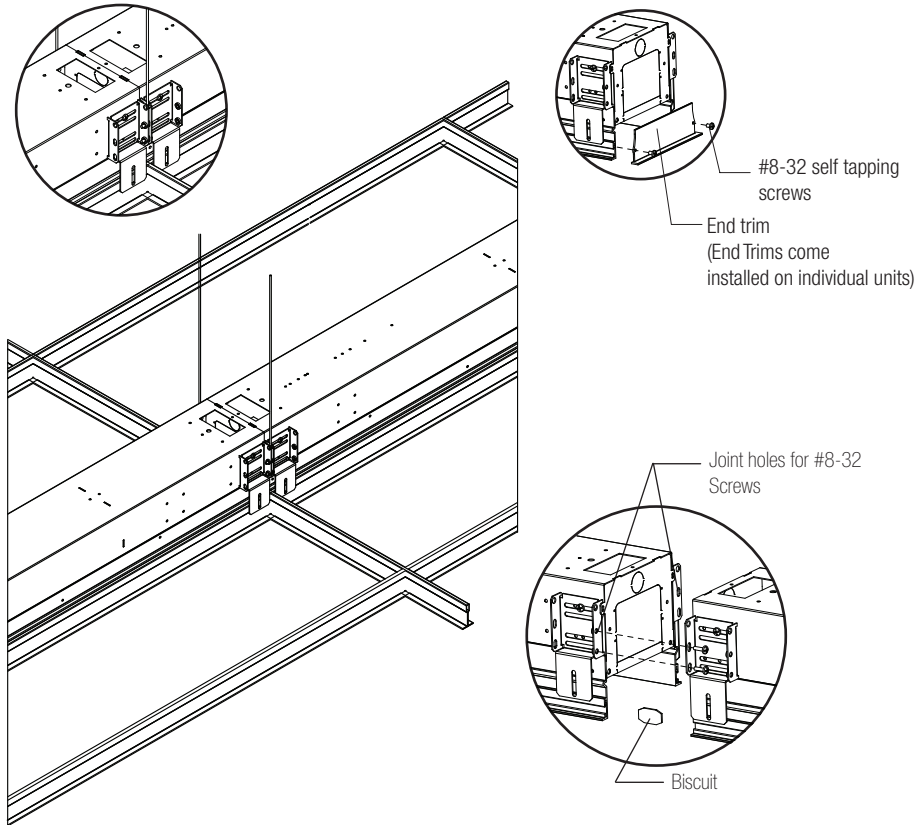

## Step 3: Continuous Runs

1. Remove knock-outs between fixtures.
2. Fixtures are through-wired for continuous runs.
3. Install end trim on all non joining ends.
4. Make necessary wiring connections between fixtures.
5. Align fixtures using supplied biscuits (2) and secure fixtures together using supplied #8-32 screws (2).

## Step 4: Finishing

1. Install lamps.
2. Install lens or louver.
3. Secure fixture to grid through all Grid Brackets.

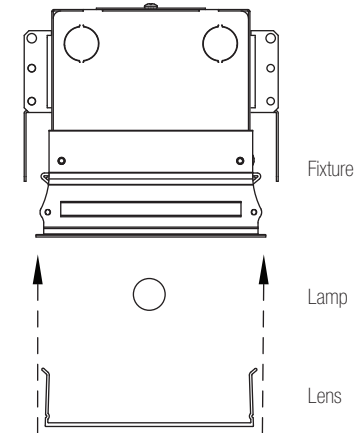

1. This product must be installed in accordance with applicable installation and electrical codes by a professional familiar with the construction and operation of the product.
2. Minimum 90°C supply conductors
3. All electrical connections must be performed by a certified electrician to applicable local and national electrical codes.
4. Fixtures must be mounted directly to structure.

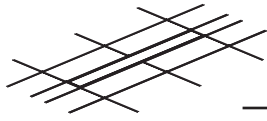

**EDGE**  
EVOLUTION 6

# T5/ T5HO/ T8 & LED Grid Ceiling Installation

[Return to  
Main Menu](#)

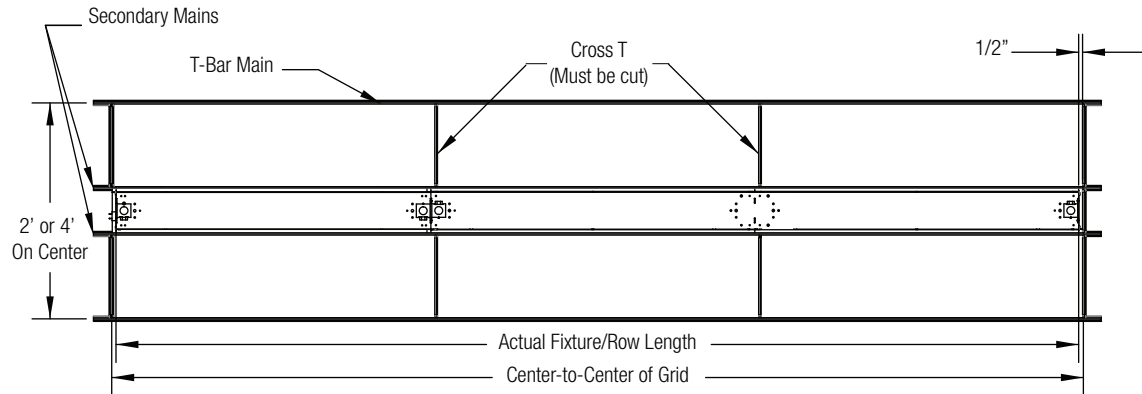

\* Overall fixture or row length for recessed fixtures is 1" less than the center-to-center of the grid to fall "On-Grid" and fit within the T-bar opening.

Nominal Fixture length (Bold) Verses Actual Length (T5/T8)					
Fixture	2'	3'	4'	6'	8'
BOR/INT	xx	xx	48"	72"	96"
EOR/IND	23"	35"	47"	71"	95"

BOR - Beginning of run  
INT - Intermediate fixture  
EOR - End of run  
IND - individual fixture

## Row Configuration Notes:

- Actual row lengths may vary from "Nominal".
- The over all rows do fall "On-Grid" and require additional T-Bar "mains" along the length of the row.
- Actual overall row length may be calculated using table above.
- Fixture runs require one (1) EOR/IND fixture in order to fall "On-Grid".
- Battery fixtures have test switch and indicator light remoted (conduit and J-Box by others).

Row Configuration Chart

Nominal Row Length	Actual Row Length	Fixture Units in Row Configuration
2 ft	1' 11"	23"
3 ft	2' 11"	35"
4 ft	3' 11"	47"
5 ft	4' 10"	23" + 35"
6 ft	5' 11"	71"
7 ft	6' 11"	48" + 35"
8 ft	7' 11"	95"
9 ft	8' 11"	72" + 35"
10 ft	9' 11"	72" + 47"
11 ft	10' 11"	96" + 35"
12 ft	11' 11"	96" + 47"
13 ft	12' 11"	72" + 48" + 35"
14 ft	13' 11"	96" + 71"
15 ft	14' 11"	96" + 48" + 35"
16 ft	15' 11"	96" + 95"
17 ft	16' 11"	96" + 72" + 35"
18 ft	17' 11"	96" + 72" + 47"
19 ft	18' 11"	96" + 96" + 35"
20 ft	19' 11"	96" + 96" + 47"
21 ft	20' 11"	96" + 72" + 48" + 35"
22 ft	21' 11"	96" + 96" + 71"
23 ft	22' 11"	96" + 96" + 48" + 35"
24 ft	23' 11"	96" + 96" + 95"
25 ft	24' 11"	96" + 96" + 72" + 35"



1. This product must be installed in accordance with applicable installation and electrical codes by a professional familiar with the construction and operation of the product.
2. Minimum 90°C supply conductors
3. All electrical connections must be performed by a certified electrician to applicable local and national electrical codes.
4. Fixtures must be mounted directly to structure.





# EDGE Evolution6

T5/T5HO, T8 & LED  
FL-INACCESSIBLE INSTALLATION

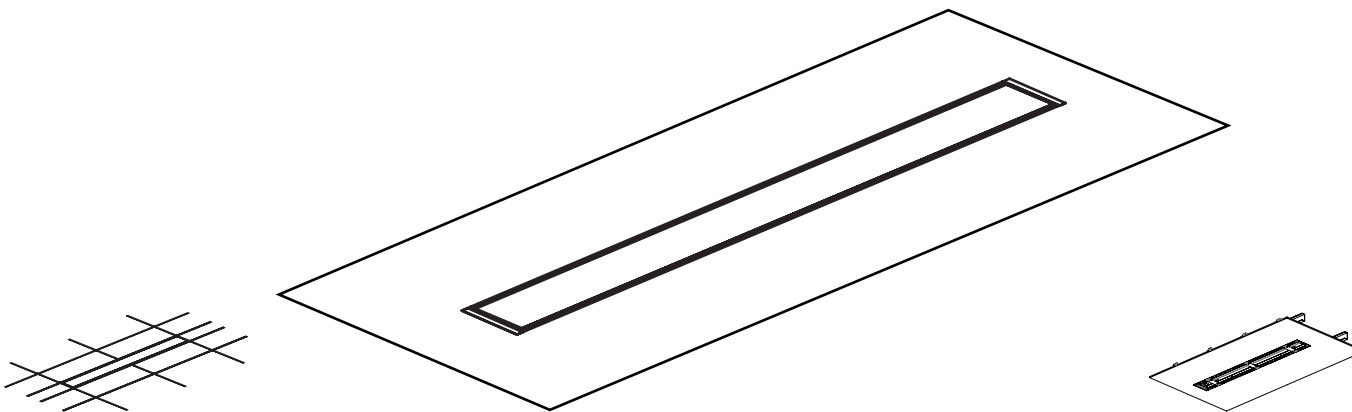

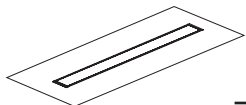

**EDGE**  
EVOLUTION 6

# T5/ T5HO/ T8 & LED Flanged - Inaccessible Installation

[Return to  
Main Menu](#)

★ Do not screw into side of housing. ★

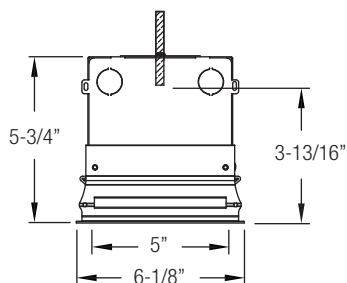

Front View

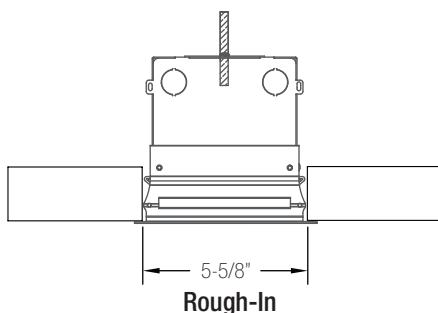

Rough-In

★ Do not block at end of fixture/ run ★  
to avoid interference with  
fixture extension (T8 only)

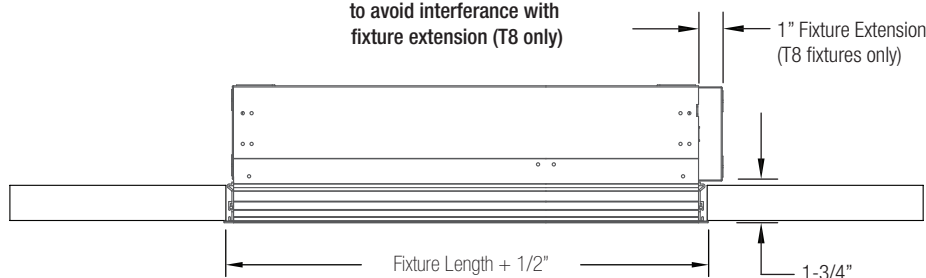

Fixture length can be found on fixture label inside of fixture. An "End Trim" may be used as a gauge for ensuring minimum width. Always install lenses during installation and louvers AFTER ALL finishing work has been completed.

## Step 1:

### Layout/ Dimensions

1. Layout fixture and threaded rod locations. (see page 3)
2. Layout and install junction boxes and whip out below ceiling level.
3. Install 1/4-20 threaded rod to structure.
4. Install ceiling material.
5. Cut out the fixture rough-in.

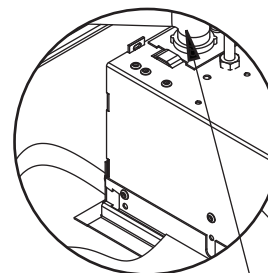

1/2" Trade Conduit  
Connector (by others)

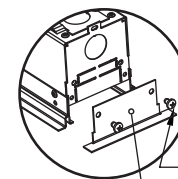

#6-20 thread forming  
screws  
End trim  
(End Trims come  
installed on individual units)

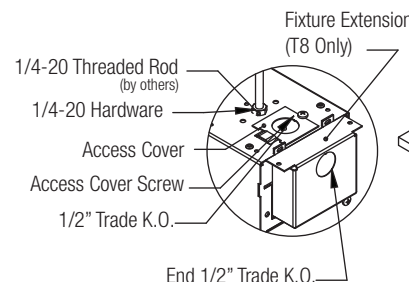

## Step 2:

### Making the Connections

1. Attach end trim to end fixtures using #6-20 thread forming screws.
2. Remove applicable access cover.
3. Attach conduit to access cover using 1/2" trade fittings.
4. Make electrical connections inside fixture.
5. Replace access cover.



1. This product must be installed in accordance with applicable installation and electrical codes by a professional familiar with the construction and operation of the product.
2. Minimum 90°C supply conductors
3. All electrical connections must be performed by a certified electrician to applicable local and national electrical codes.
4. Fixtures must be mounted directly to structure.



**EDGE**  
EVOLUTION 6

# T5/ T5HO/ T8 & LED Flanged - Inaccessible Installation

[Return to  
Main Menu](#)

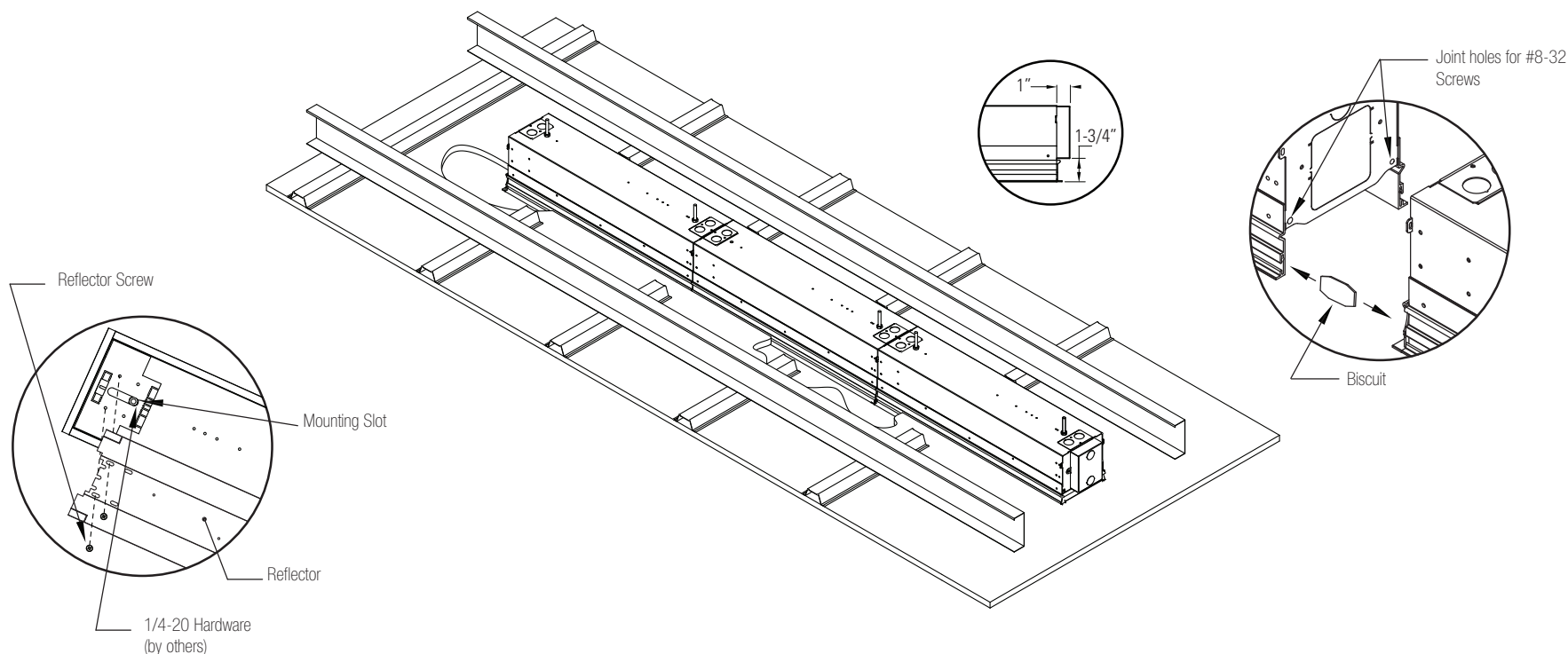

## Step 3: Individual or First Fixture

1. Remove lens or louver and reflector.
2. Surface mount fixture through mounting slot to threaded rod.
3. If first fixture remove end knock outs for through wiring.

## Step 4: Continuous Rows

1. Remove lens or louver and reflector.
2. Fixtures are through-wired for continuous runs.
3. Remove end knock-outs between fixtures.
4. Lift and rotate fixture into place.
5. Surface mount fixture through mounting slot to threaded rod.
6. Make necessary wiring connections between fixtures.
7. Align fixtures using supplied biscuits (2) and secure fixtures together using supplied #8-32 screws (2).



1. This product must be installed in accordance with applicable installation and electrical codes by a professional familiar with the construction and operation of the product.
2. Minimum 90°C supply conductors
3. All electrical connections must be performed by a certified electrician to applicable local and national electrical codes.
4. Fixtures must be mounted directly to structure.



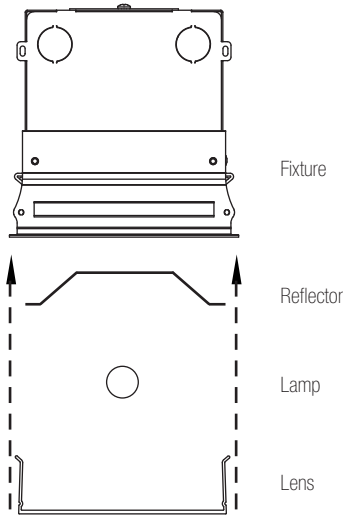
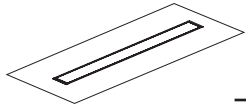

## Step 5: Finishing

1. Re-install reflector.
2. Install lamps.
3. Install lens or louver.

6' and 8' fixtures

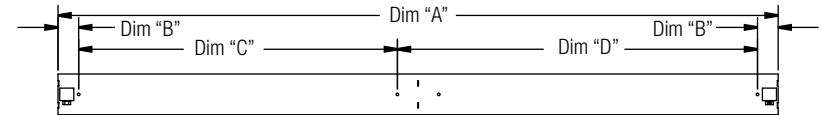

First or Intermediate Fixture

"A"	"B"	"C"	"D"
96"	2-5/16"	44-1/8"	47-5/16"
72"	2-5/16"	32-1/8"	35-1/4"
48"	2-5/16"	43-3/8"	n/a

"A"	Overall Actual Fixture Length
"B"	First Rod Location
"C"	Second Rod Location
"D"	Third Rod Location (6' and 8' Fixture Only)

4' fixtures

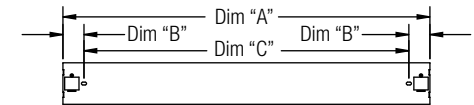

6' and 8' fixtures

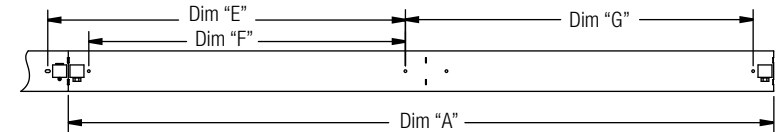

Individual or Final Fixture

"A"	"E"	"F"	"G"
95"	48-3/4"	44-1/8"	46-1/4"
71"	36-3/4"	32-1/8"	34-1/4"
47"	47"	42-3/8"	n/a
35"	35"	30-3/8"	n/a
23"	23"	18-3/8"	n/a

	First Rod Location
"E"	Second Rod Location
"G"	Third Rod Location (6' and 8' Fixture Only)

2' 3' and 4' fixtures

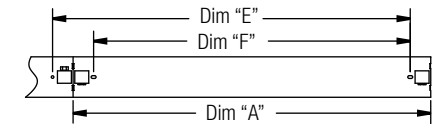



# EDGE Evolution6

T5/T5HO, T8 & LED  
NF-INACCESSIBLE INSTALLATION

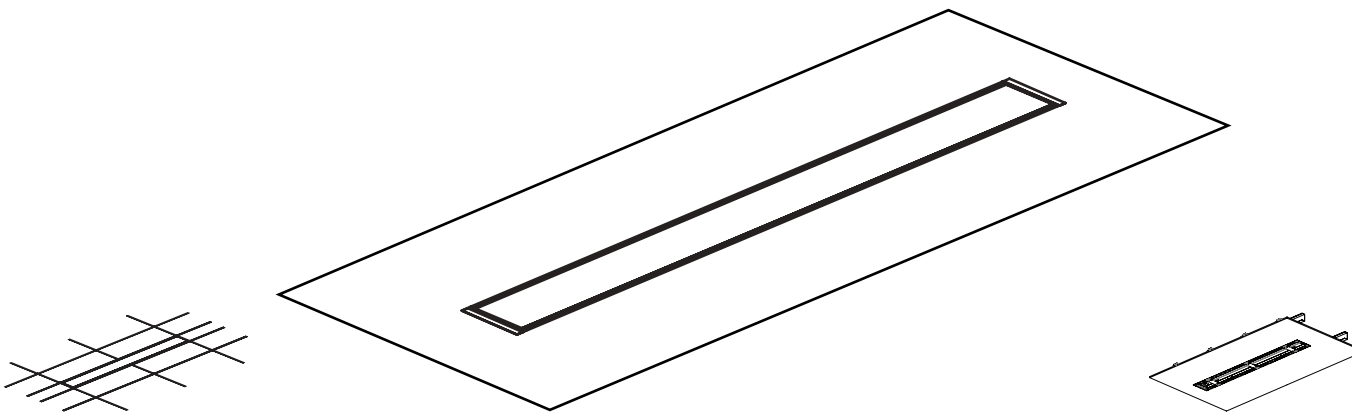



**EDGE**  
EVOLUTION 6

# T5/ T5HO/ T8 & LED Non Flanged - Inaccessible Installation

[Return to  
Main Menu](#)

★ Do not screw into side of housing. ★

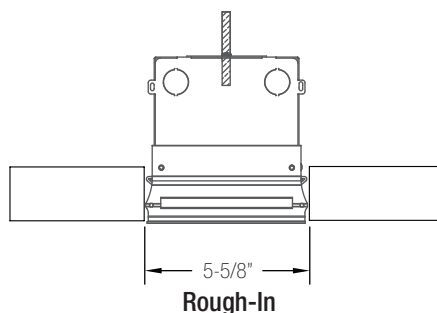
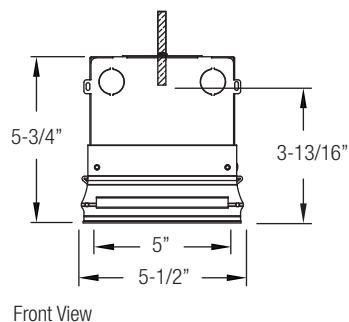

★ Do not block at end of fixture/ run ★  
to avoid interference with  
fixture extension (T8 only)

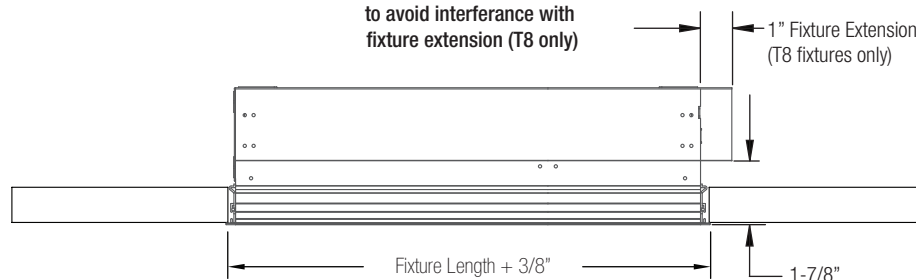

Fixture length can be found on fixture label inside of fixture. An "End Trim" may be used as a gauge for ensuring minimum width. Always install lenses during installation and louvers AFTER ALL finishing work has been completed.

## Step 1:

### Layout/ Dimensions

1. Layout fixture and threaded rod locations.
2. Layout and install junction boxes and whip out below ceiling level.
3. Install 1/4-20 threaded rod to structure.
4. Install ceiling material.
5. Cut out the fixture rough-in.

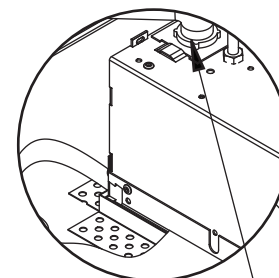

1/2" Trade Conduit  
Connector (by others)

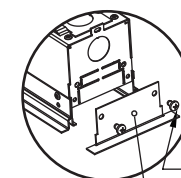

#6-20 Thread Forming  
screws  
End trim  
(End Trims come  
installed on individual units)

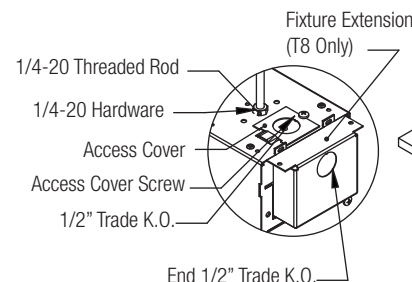

## Step 2:

### Making the Connections

1. Attach end trim to end fixtures using #6-20 thread forming screws.
2. Remove applicable access cover.
3. Attach conduit to access cover using 1/2" trade fittings.
4. Make electrical connections inside fixture.
5. Replace access cover.



Designed and Fabricated in Denver Colorado

Phone: 303.322.5570

[www.pinnacle-ltg.com](http://www.pinnacle-ltg.com)

EV6\_Booklet\_DEC2015

1. This product must be installed in accordance with applicable installation and electrical codes by a professional familiar with the construction and operation of the product.
2. Minimum 90°C supply conductors
3. All electrical connections must be performed by a certified electrician to applicable local and national electrical codes.
4. Fixtures must be mounted directly to structure.

© 2015 Pinnacle Architectural Lighting

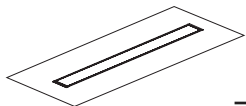

**EDGE**  
EVOLUTION 6

# T5/ T5HO/ T8 & LED Non Flanged - Inaccessible Installation

[Return to  
Main Menu](#)

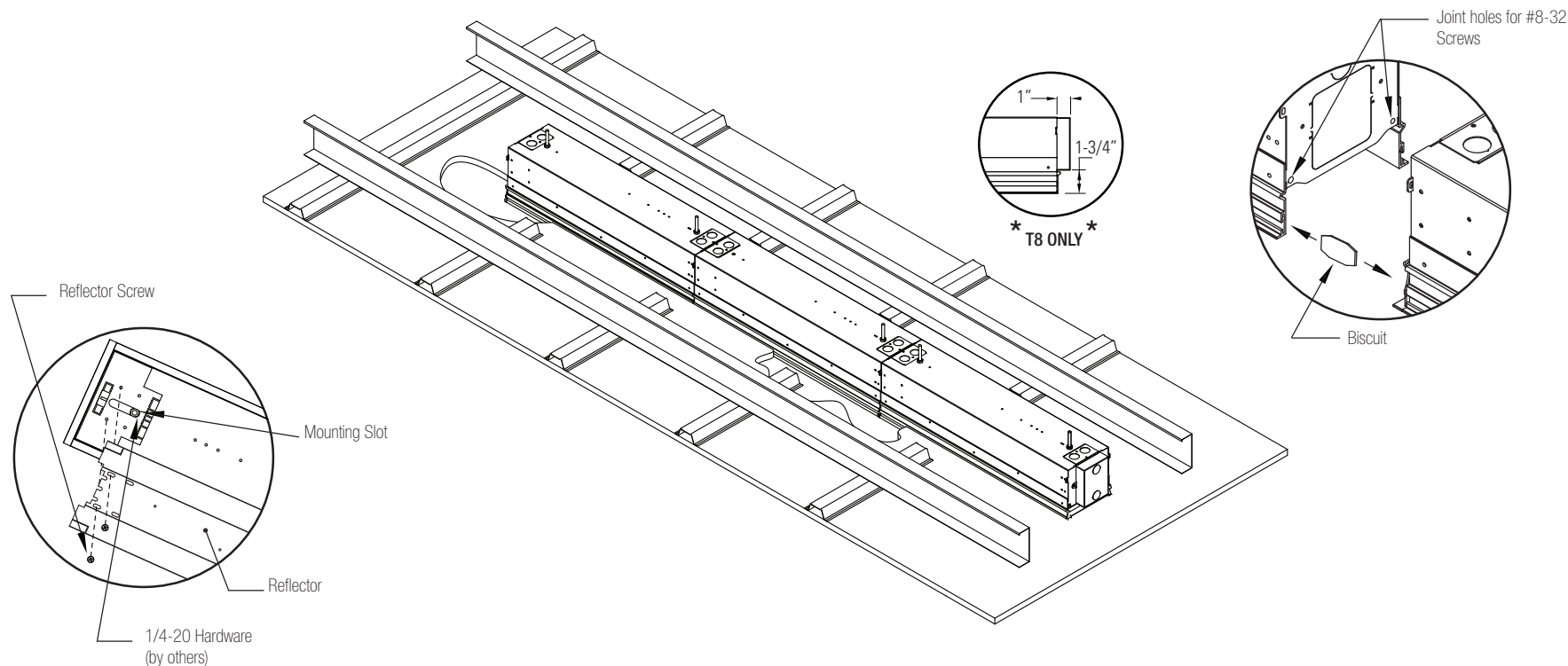

## Step 3: Individual or First Fixture

1. Remove lens or louver and reflector.
2. Surface mount fixture through mounting slot to threaded rod.
3. If first fixture, remove end knock outs for through wiring.

## Step 4: Continuous Rows

1. Remove lens or louver and reflector.
2. Fixtures are through-wired for continuous runs.
3. Remove end knock-outs between fixtures.
4. Install end trim on all non joining ends.
5. Surface mount fixture through mounting slot to threaded rod.
6. Make necessary wiring connections between fixtures.
7. Secure fixtures together using supplied #8-32 Screws.



1. This product must be installed in accordance with applicable installation and electrical codes by a professional familiar with the construction and operation of the product.
2. Minimum 90°C supply conductors
3. All electrical connections must be performed by a certified electrician to applicable local and national electrical codes.
4. Fixtures must be mounted directly to structure.

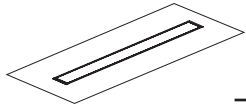

**EDGE**  
EVOLUTION 6

# T5/ T5HO/ T8 & LED Non Flanged - Inaccessible Installation

Return to  
Main Menu

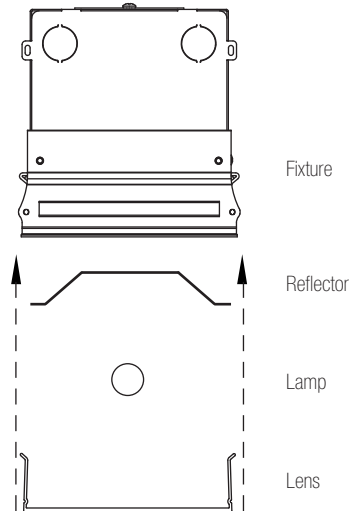
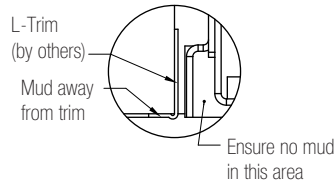

## Step 5: Finishing

1. Re-install reflector.
2. Install lamps.
3. Install lens or louver.

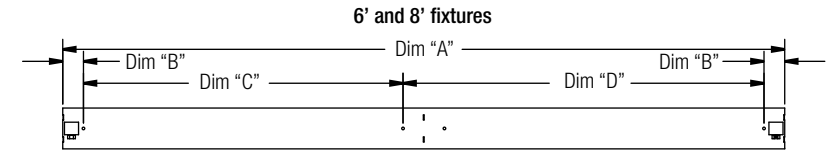

### First or Intermediate Fixture

"A"	"B"	"C"	"D"
96"	2-5/16"	44-1/8"	47-5/16"
72"	2-5/16"	32-1/8"	35-1/4"
48"	2-5/16"	43-3/8"	n/a

"A" Overall Actual Fixture Length  
"B" First Rod Location  
"C" Second Rod Location  
"D" Third Rod Location (6' and 8' Fixture Only)

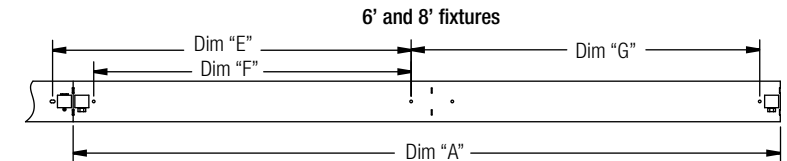
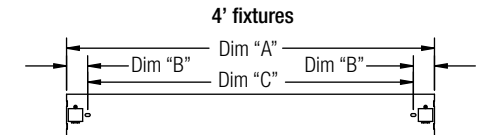

### Individual or Final Fixture

"A"	"E"	"F"	"G"
95"	48-3/4"	44-1/8"	46-1/4"
71"	36-3/4"	32-1/8"	34-1/4"
47"	47"	42-3/8"	n/a
35"	35"	30-3/8"	n/a
23"	23"	18-3/8"	n/a

First Rod Location  
"E" Second Rod Location  
"G" Third Rod Location (6' and 8' Fixture Only)

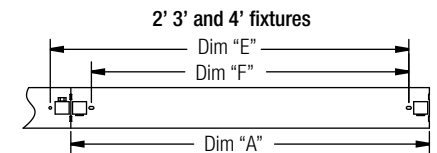

1. This product must be installed in accordance with applicable installation and electrical codes by a professional familiar with the construction and operation of the product.
2. Minimum 90°C supply conductors
3. All electrical connections must be performed by a certified electrician to applicable local and national electrical codes.
4. Fixtures must be mounted directly to structure.





# EDGE Evolution6

T5/T5HO, T8 & LED  
SPACKLE FLANGE MOUNTING

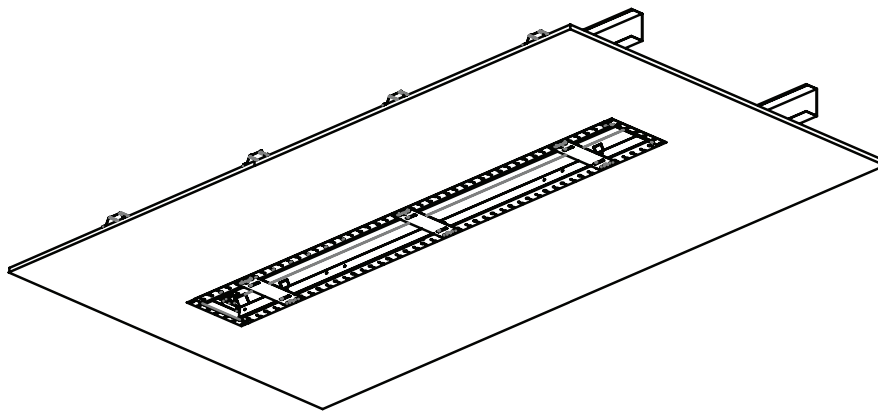
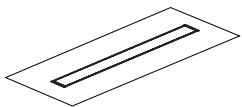
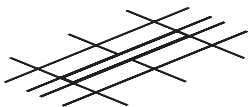

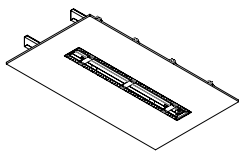

**EDGE**  
EVOLUTION 6

# T5/ T5HO/ T8 & LED Spackle Flange Mounting

[Return to  
Main Menu](#)

**\*SUGGESTED LEVEL 5 DRYWALL FINISH\***

**\* DO NOT SCREW INTO SIDE OF HOUSING \***  
**DO NOT REMOVE CROSS BRACKETS**  
**UNTIL FIXTURE IS INSTALLED**

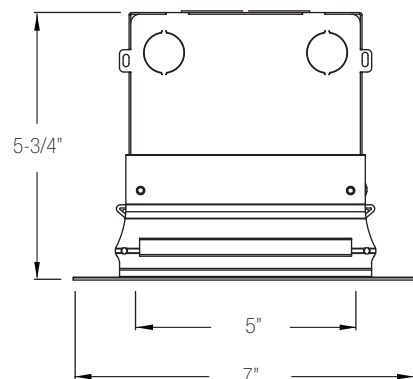

Front View

Recommended opening = 5-5/8"

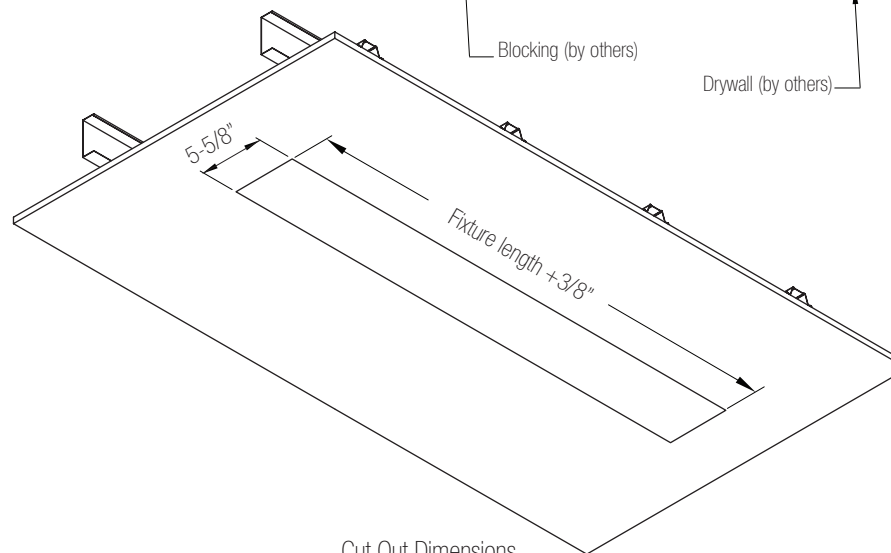
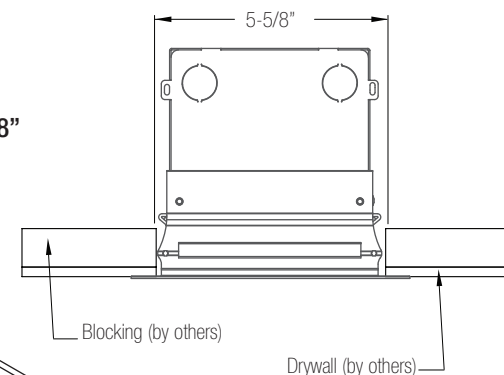

Cut Out Dimensions

Note: Fixture length may be found on fixture label inside fixture.

## Step 1:

### Layout/ Dimensions

1. Layout fixtures and blocking locations.
2. Layout and install junction boxes and whip out.
3. Install blocking to structure using rough in dimensions.
4. Install ceiling material.
5. Cut out the fixture/row rough-in.



1. This product must be installed in accordance with applicable installation and electrical codes by a professional familiar with the construction and operation of the product.
2. Minimum 90°C supply conductors
3. All electrical connections must be performed by a certified electrician to applicable local and national electrical codes.
4. Fixtures must be mounted directly to structure.

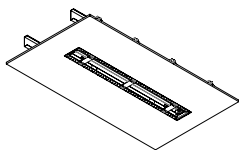

**EDGE**  
EVOLUTION 6

## T5/ T5HO/ T8 & LED Spackle Flange Mounting

[Return to  
Main Menu](#)

**\*SUGGESTED LEVEL 5 DRYWALL FINISH\***

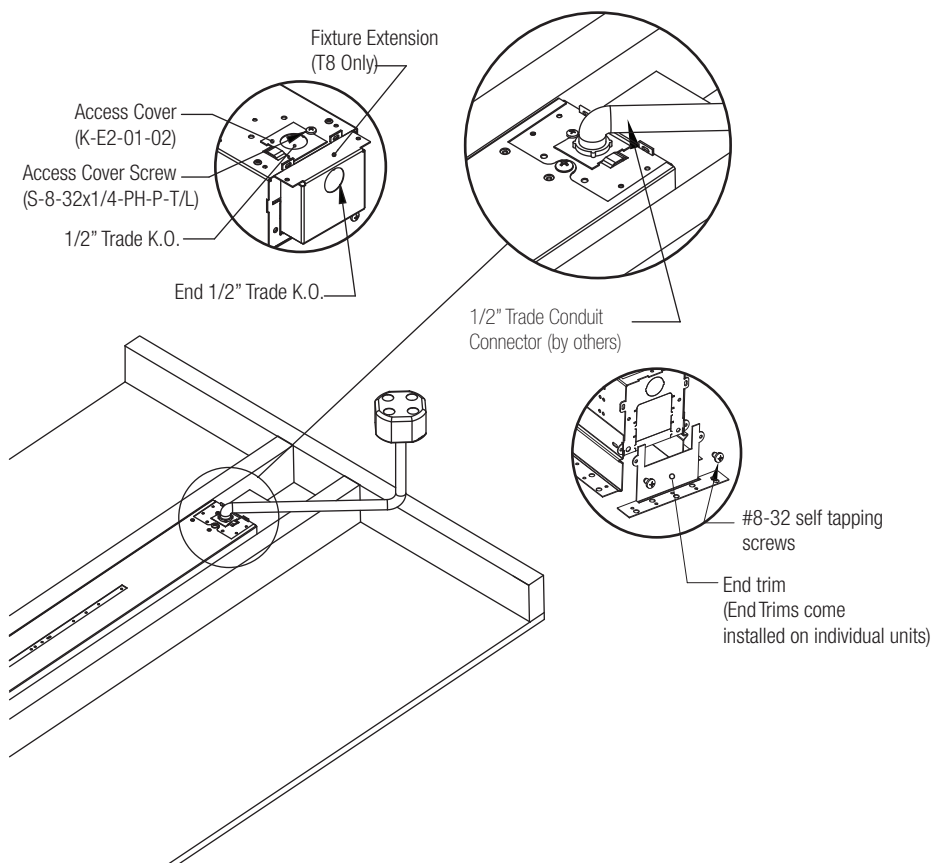

### Step 2: Making the Connections

1. Attach end trim to end fixtures using #8-32 self tapping screws.
2. Remove applicable access cover.
3. Attach conduit to access cover using 1/2" trade fittings.
4. Replace access cover.

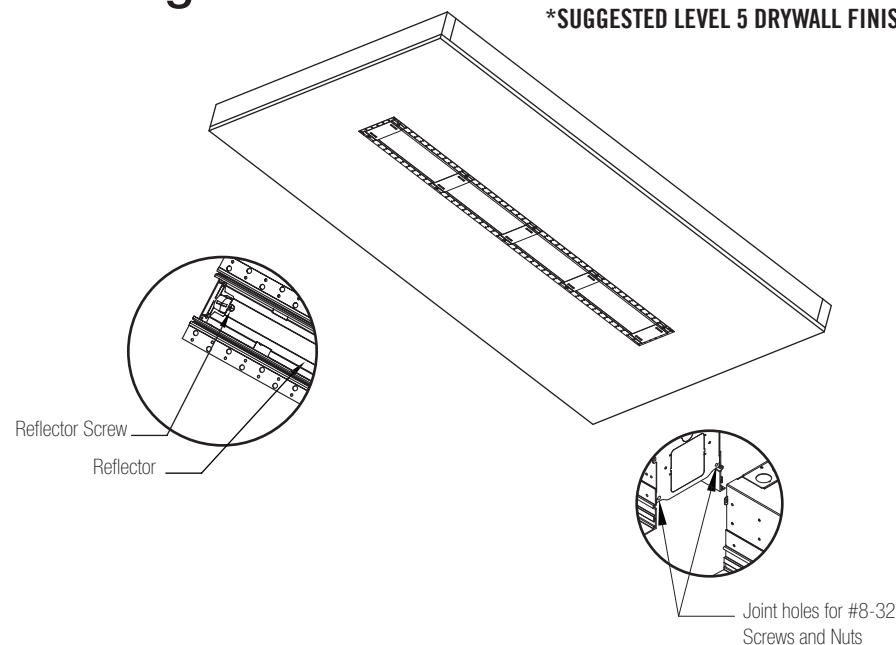

### Step 3: Mounting

1. Position fixture in roughed and blocked in opening.
2. Mount the fixture in place by putting a screw in behind each cross bracket along the length of the fixture (each side) and two on each end flange.
3. Once mounted remove cross brackets and discard.
4. Remove reflector to wire to building power.

### For Continuous Runs

1. Remove end knock-outs between fixtures.
2. Install end trim on all non joining ends.
3. Lift and rotate fixtures into place and secure fixture using mounting hardware.
4. Mount fixture in place by putting a screw behind each cross bracket (each side) along the length of the fixture.
5. Remove cross brackets and discard.
6. Remove reflector and make necessary wiring connections between fixtures.
7. Secure fixtures together using supplied #8-32 screws.

1. This product must be installed in accordance with applicable installation and electrical codes by a professional familiar with the construction and operation of the product.
2. Minimum 90°C supply conductors
3. All electrical connections must be performed by a certified electrician to applicable local and national electrical codes.
4. Fixtures must be mounted directly to structure.



Designed and Fabricated in Denver Colorado

Phone: 303.322.5570

[www.pinnacle-ltg.com](http://www.pinnacle-ltg.com)

EV6\_Booklet\_DEC2015

© 2015 Pinnacle Architectural Lighting

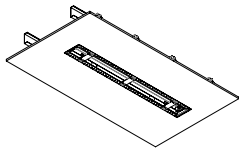

**EDGE**  
EVOLUTION 6

# T5/ T5HO/ T8 & LED Spackle Flange Mounting

[Return to  
Main Menu](#)

**\*SUGGESTED LEVEL 5 DRYWALL FINISH\***

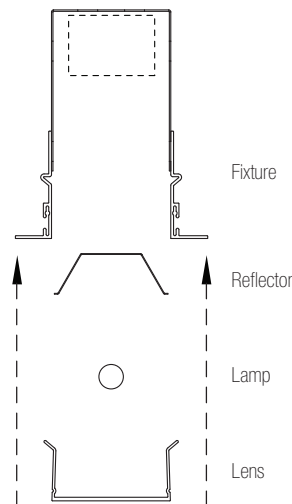
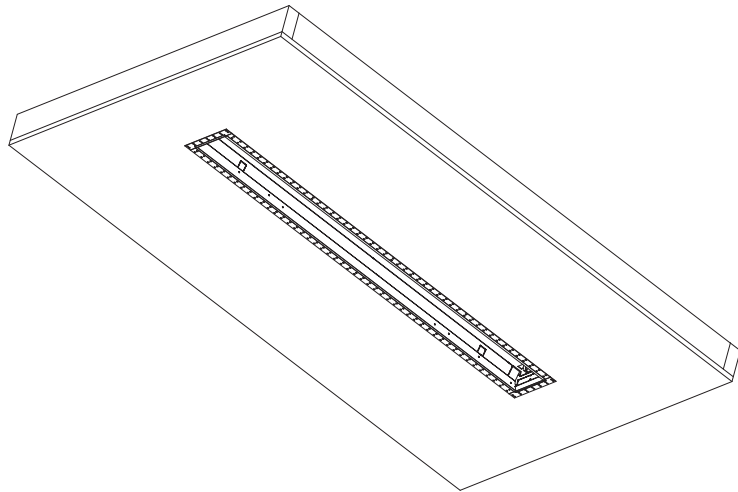

## Step 4: Finishing

1. Replace reflector
2. Install lamp(s)
3. Install lens or louver.

## Row Configuration Notes:

EOR/IND fixtures are less than nominal in length.

Row configurations shown are standard.

Non-standard row configurations may be specified for your project and will be shown on a project submittal. Overall row lengths and rough-in lengths will be shown on the submittal. Standard rows for project typically do not have submittal drawings.

All fixtures are modular and may be used in any location (except special circuits)

Special circuit fixtures should be installed in the locations specified.

In general, installation is assumed to use the largest fixture first, followed by the next largest, etc.

Add 1/4" to overall row length for rough-in.

Battery fixtures have test switch and indicator light remoted (conduit and J-Box by others).

All fixtures through-wired for specified circuits. Quick connects provided between fixtures.

Fixtures are manufactured so that the fixture label (located on reflector) is closest to the start of the row. Subsequent fixtures are installed with the label closest to the previous fixture.

BOR - Beginning of Run, INT - Intermediate Fixture, EOR - End of Run, IND - Individual Fixture

## Row Configuration Chart

Nominal Row Length	Actual Row Length	Fixture Units in Row Configuration
2 ft	1' 11"	23'
3 ft	2' 11"	35'
4 ft	3' 11"	47'
5 ft	4' 10"	35' + 23'
6 ft	5' 11"	71'
7 ft	6' 11"	48' + 35'
8 ft	7' 11"	95'
9 ft	8' 11"	72' + 35'
10 ft	9' 11"	72' + 47'
11 ft	10' 11"	96' + 35'
12 ft	11' 11"	96' + 47'
13 ft	12' 11"	72' + 48' + 35'
14 ft	13' 11"	96' + 71'
15 ft	14' 11"	96' + 48' + 35'
16 ft	15' 11"	96' + 95'
17 ft	16' 11"	96' + 72' + 35'
18 ft	17' 11"	96' + 72' + 47'
19 ft	18' 11"	96' + 96' + 35'
20 ft	19' 11"	96' + 96' + 47'
21 ft	20' 11"	96' + 72' + 48' + 35'
22 ft	21' 11"	96' + 96' + 71'
23 ft	22' 11"	96' + 96' + 48' + 35'
24 ft	23' 11"	96' + 96' + 95'
25 ft	24' 11"	96' + 96' + 72' + 35'

## Nominal Fixture Length Versus Actual Length (T5 & T8)

Fixture	2'	3'	4'	6'	8'
BOR/INT	XX	XX	48"	72"	96"
EOR/IND	23"	35"	47"	71"	95"

1. This product must be installed in accordance with applicable installation and electrical codes by a professional familiar with the construction and operation of the product.
2. Minimum 90°C supply conductors
3. All electrical connections must be performed by a certified electrician to applicable local and national electrical codes.
4. Fixtures must be mounted directly to structure.



Designed and Fabricated in Denver Colorado

Phone: 303.322.5570

[www.pinnacle-ltg.com](http://www.pinnacle-ltg.com)

EV6\_Booklet\_DEC2015

© 2015 Pinnacle Architectural Lighting



# EDGE Evolution6

T5/T5H0

STAGGERED FIXTURE ROW LAYOUT

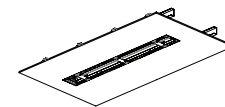
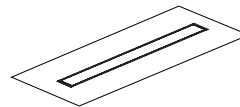
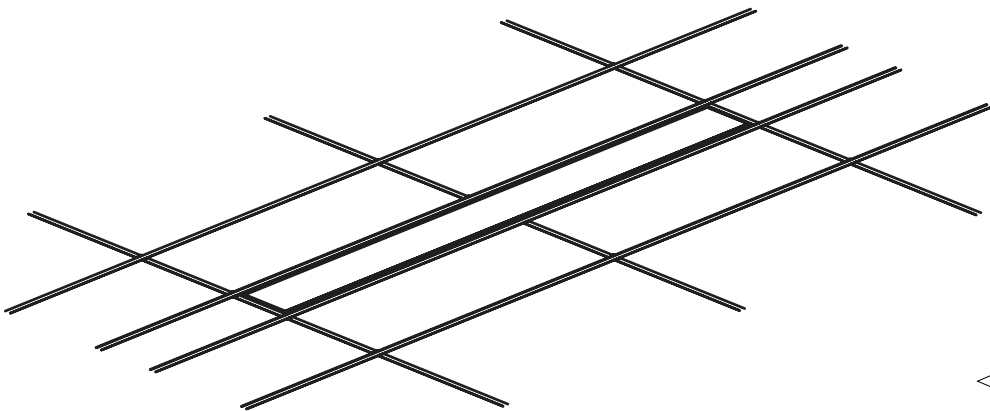



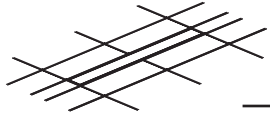

**EDGE**  
EVOLUTION 6

# T5/ T5HO Staggered Row Layout Breakdown

[Return to  
Main Menu](#)

Nominal Length	Actual Length	Lamp Totals	Configuration
6 ft	5' 11"	2ft = 2, 3ft = 1	
7 ft	6' 11"	2ft = 1, 3ft = 2	
8 ft	7' 11"	3ft = 3	
9 ft	8' 11"	3ft = 2, 4ft = 1	
10 ft	9' 11"	2ft = 3, 3ft = 2	
11 ft	10' 11"	2ft = 2, 3ft = 3	
12 ft	11' 11"	2ft = 2, 3ft = 2, 4ft = 1	
13 ft	12' 11"	2ft = 1, 3ft = 3, 4ft = 1	
14 ft	13' 11"	2ft = 4, 3ft = 3	
15 ft	14' 11"	2ft = 3, 3ft = 4	

*NOTE: Rows must be assembled in order shown. Rows cannot be reconfigured.*

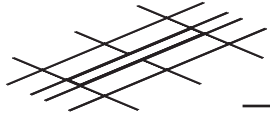

**EDGE**  
EVOLUTION 6

# T5/ T5HO Staggered Row Layout Breakdown

[Return to  
Main Menu](#)

Nominal Length	Actual Length	Lamp Totals	Configuration
16 ft	15' 11"	2ft = 2, 3ft = 5	
17 ft	16' 11"	2ft = 2, 3ft = 4, 4ft = 1	
18 ft	17' 11"	2ft = 5, 3ft = 4	
19 ft	18' 11"	2ft = 4, 3ft = 5	
20 ft	19' 11"	2ft = 4, 3ft = 4, 4ft = 1	
21 ft	20' 11"	2ft = 3, 3ft = 5, 4ft = 1	
22 ft	21' 11"	2ft = 6, 3ft = 5	
23 ft	22' 11"	2ft = 5, 3ft = 6	
24 ft	23' 11"	2ft = 4, 3ft = 7	

*NOTE: Rows must be assembled in order shown. Rows cannot be reconfigured.*



# EDGE Evolution6 <sup>T8</sup> STAGGERED FIXTURE ROW LAYOUT

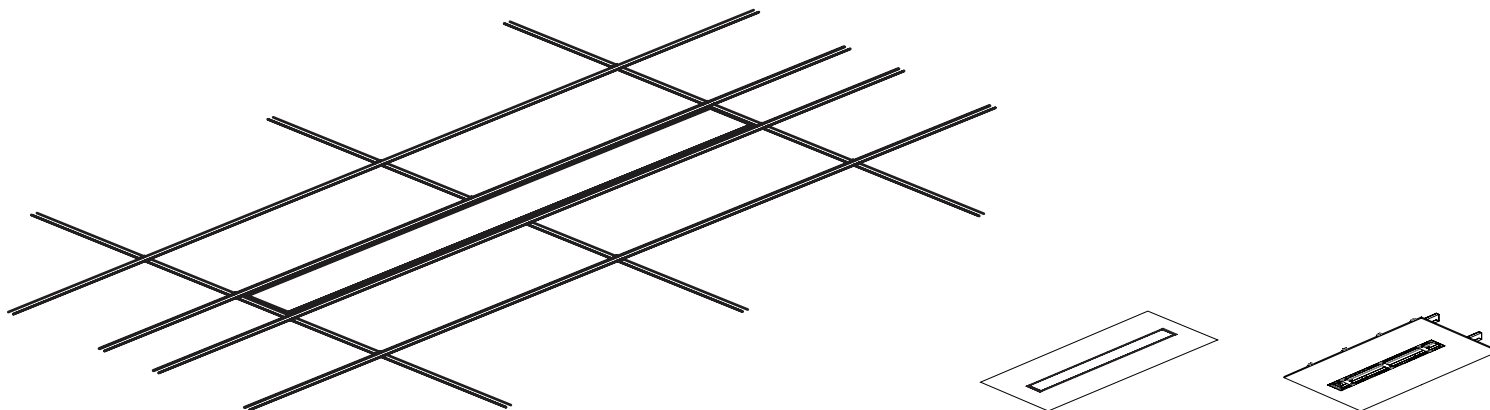

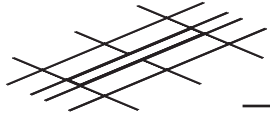

**EDGE**  
EVOLUTION 6

# T8 Staggered Row Layout Breakdown

[Return to  
Main Menu](#)

Nominal Length	Actual Length	Lamp Totals	Configuration
6 ft	5' 11"	2ft = 2, 3ft = 1	
7 ft	6' 11"	2ft = 1, 3ft = 2	
8 ft	7' 11"	3ft = 3	
9 ft	8' 11"	3ft = 2, 4ft = 1	
10 ft	9' 11"	2ft = 1, 3ft = 3	
11 ft	10' 11"	3ft = 4	
12 ft	11' 11"	3ft = 2, 4ft = 1	
13 ft	12' 11"	2ft = 1, 3ft = 3, 4ft = 1	
14 ft	13' 11"	2ft = 2, 3ft = 4	
15 ft	14' 11"	2ft = 1, 3ft = 5	

*NOTE: Rows must be assembled in order shown. Rows cannot be reconfigured.*

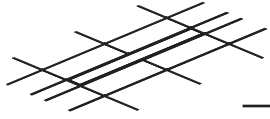

**EDGE**  
EVOLUTION 6

# T8 Staggered Row Layout Breakdown

[Return to  
Main Menu](#)

Nominal Length	Actual Length	Lamp Totals	Configuration
16 ft	15' 11"	3ft = 6	
17 ft	16' 11"	3ft = 5, 4ft = 1	
18 ft	17' 11"	2ft = 1, 3ft = 6	
19 ft	18' 11"	3ft = 7	
20 ft	19' 11"	3ft = 6, 4ft = 1	
21 ft	20' 11"	2ft = 1, 3ft = 6, 4ft = 1	
22 ft	21' 11"	2ft = 2, 3ft = 7	
23 ft	22' 11"	2ft = 1, 3ft = 8	
24 ft	23' 11"	3ft = 9	

*NOTE: Rows must be assembled in order shown. Rows cannot be reconfigured.*





# EDGE Evolution6

2 LAMP  
STAGGERED FIXTURE ROW LAYOUT

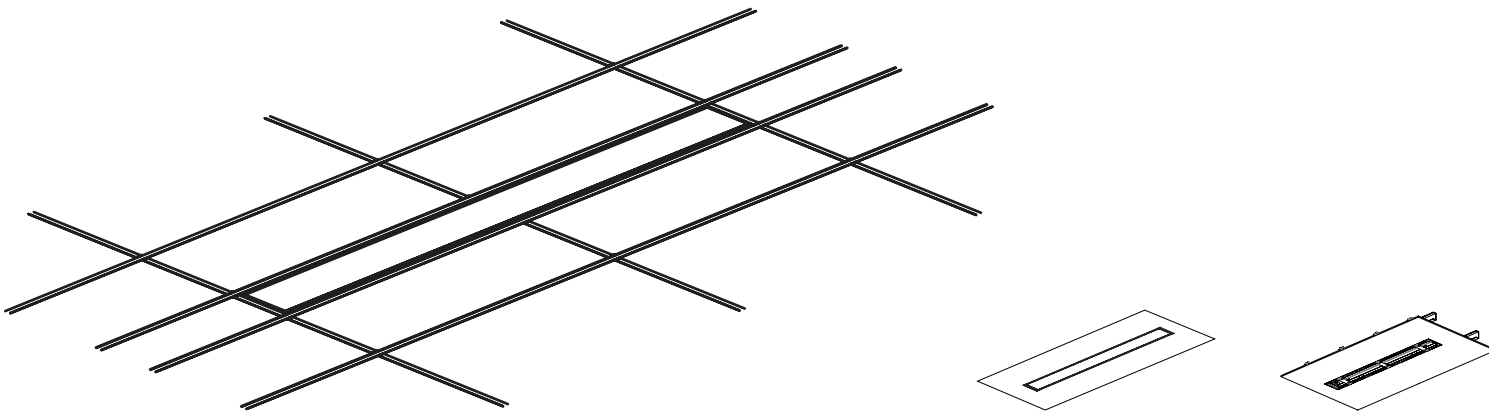

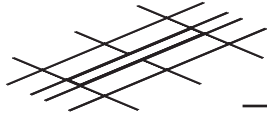

**EDGE**  
EVOLUTION 6

## 2 Lamp Staggered Row Layout Breakdown

[Return to  
Main Menu](#)

Nominal Length	Actual Length	Lamp Totals	Configuration
6 ft	5' 11"	2ft = 1, 3ft = 2, 4ft = 1	
7 ft	6' 11"	2ft = 2, 3ft = 2, 4ft = 1	
8 ft	7' 11"	2ft = 2, 4ft = 3	
9 ft	8' 11"	2ft = 1, 3ft = 4, 4ft = 1	
10 ft	9' 11"	2ft = 1, 3ft = 2, 4ft = 3	
11 ft	10' 11"	2ft = 2, 3ft = 2, 4ft = 3	
12 ft	11' 11"	2ft = 2, 4ft = 5	
13 ft	12' 11"	2ft = 1, 3ft = 4, 4ft = 3	
14 ft	13' 11"	2ft = 1, 3ft = 2, 4ft = 5	
15 ft	14' 11"	2ft = 2, 3ft = 2, 4ft = 5	

*NOTE: Rows must be assembled in order shown. Rows cannot be reconfigured.*

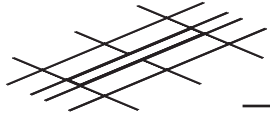

**EDGE**  
EVOLUTION 6

## 2 Lamp Staggered Row Layout Breakdown

[Return to  
Main Menu](#)

Nominal Length	Actual Length	Lamp Totals	Configuration
16 ft	15' 11"	2ft = 2, 4ft = 7	
17 ft	16' 11"	2ft = 2, 3ft = 6, 4ft = 3	
18 ft	17' 11"	2ft = 2, 3ft = 4, 4ft = 5	
19 ft	18' 11"	2ft = 2, 3ft = 2, 4ft = 7	
20 ft	19' 11"	2ft = 2, 4ft = 9,	
21 ft	20' 11"	2ft = 3, 3ft = 4, 4ft = 6	
22 ft	21' 11"	2ft = 1, 3ft = 2, 4ft = 9	
23 ft	22' 11"	2ft = 2, 3ft = 2, 4ft = 9	
24 ft	23' 11"	2ft = 2, 4ft = 11	

*NOTE: Rows must be assembled in order shown. Rows cannot be reconfigured.*



# EDGE Evolution6

LENS  
DETAIL

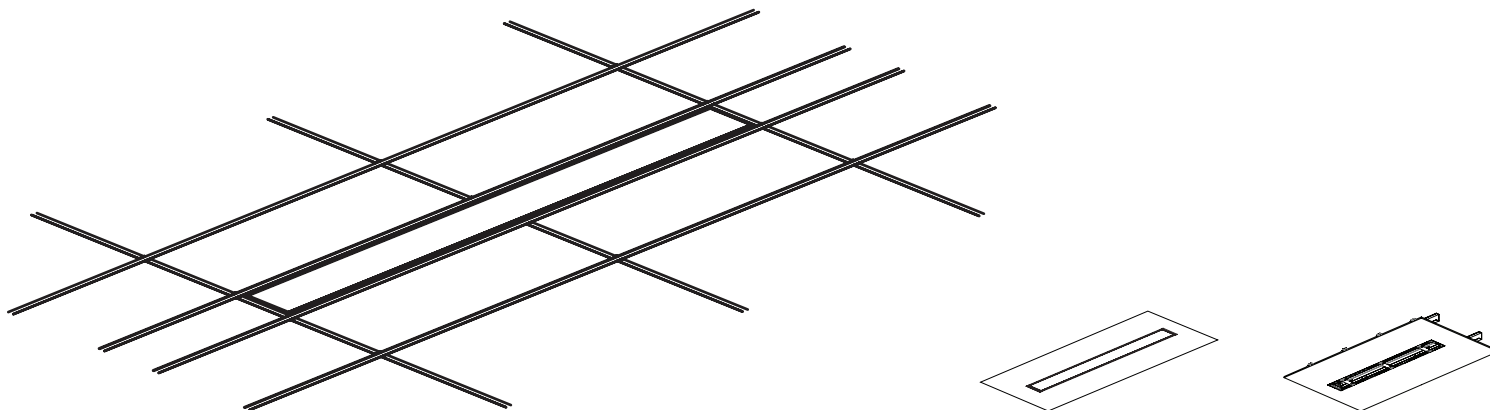

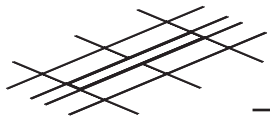

### Lens Installation

1. Begin at one end of the lens and squeeze sides to allow it to flex.
2. Insert end of lens into place, lens will snap into place when installed properly.
3. Slowly insert rest of lens down the length of the fixture

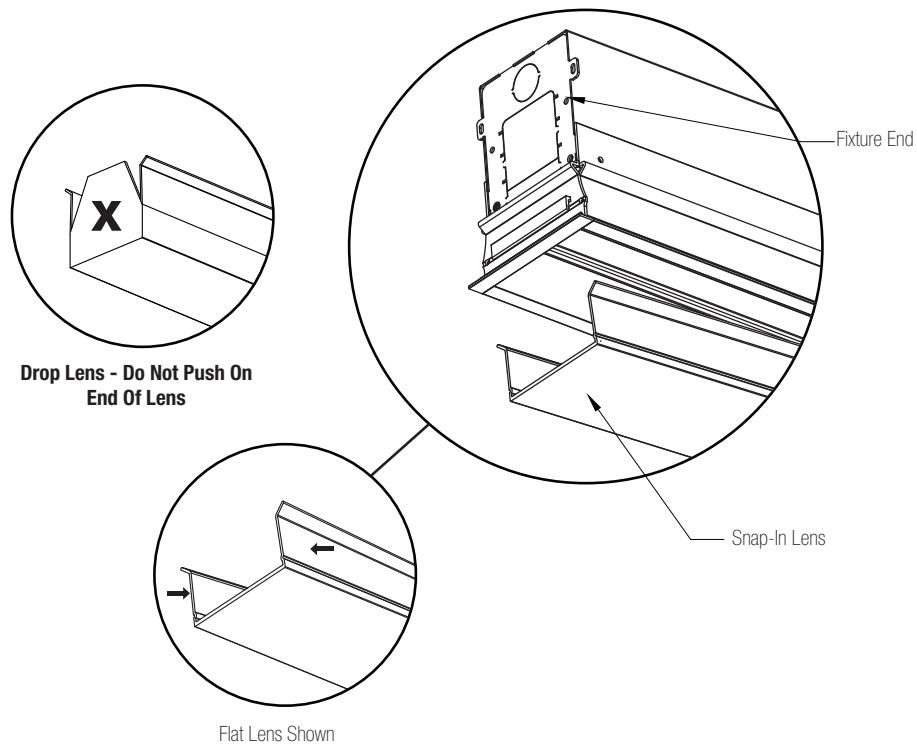

### Lens Removal

1. Insert a rigid object approx. 1/16" thick, such as a putty knife, into the edge between the lens and the fixture side about one inch from end.
2. Using said object, gently pry lens away from fixture until it is released from the mounting edge.
3. Once the section is released, start at that end of the fixture and pull the lens out of the fixture.

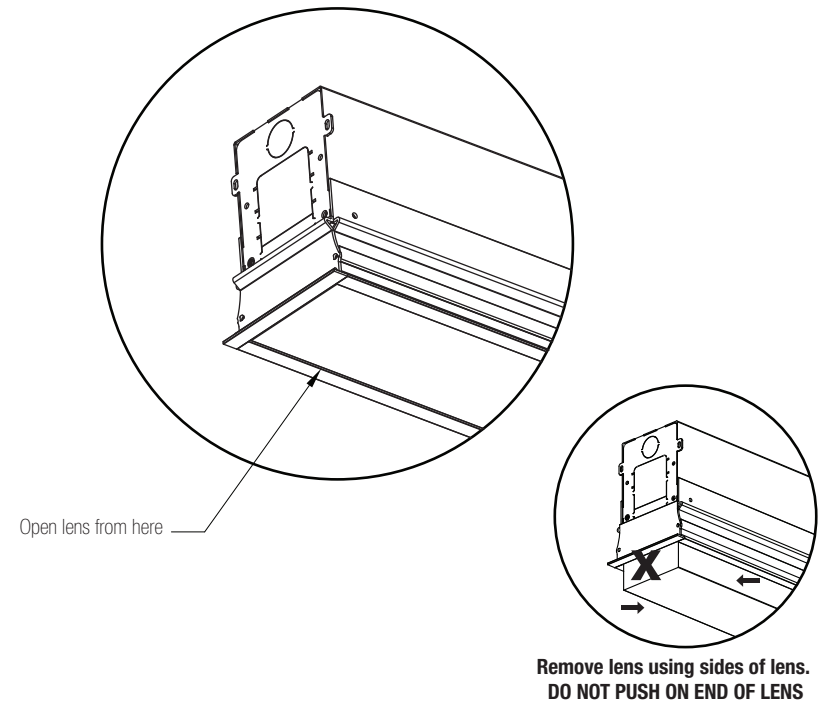

**Note:** Low temperatures can effect the lens material, making it brittle. Please allow the lenses to warm to room temperature before installation.