

Test #: 202561
Part #: EX4B-WW-O-T5-1-1-SR
Total Luminaire Efficiency: 82.0%

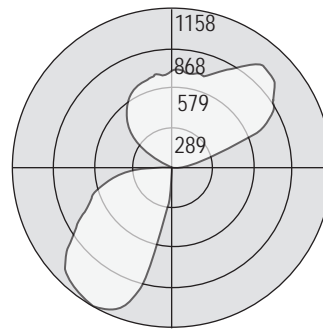

Test #: 202565
Part #: EX4B-WW-WO-T5-1-1-SR
Total Luminaire Efficiency: 82.1%

FEATURES AND OPTIONS

MR16 HALOGEN LAMP

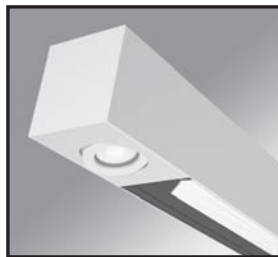
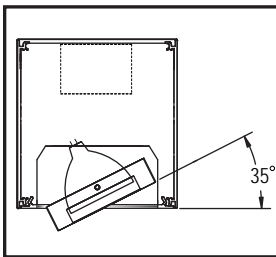

APPLICATION: EDGE EX4 and EX4B offer both task and accent lighting when used with MR16 lamps. MR16's are ideal for conference rooms, corridors, wall washing, retail spaces and training facilities. Available on direct component.

TECHNICAL: MR16 6" fully enclosed compartment eliminates light from entering into other fixture areas. Available in 20, 35 and 50 watt halogen lamps (lamps not included). Consult factory for other lamp types. Lamp tilts to 35 degrees with 358 degree rotation.

ELECTRICAL: Standard 50 watt max halogen lamp transformer. MR16 installed as independent circuit. MR16 voltage to match fluorescent voltage. Universal voltage and 347 volt not available with MR16.

LENS: MR16 available in 5 different lens options: Clear Lens (LC), Prismatic Lens (LP), Linear Spread Lens (LL), Diffuse Spread Lens (LD) and Frosted Lens (LF). Clear lens provided with each MR16.

LABELS: UL and cUL Listed, approved for dry/damp location unless otherwise noted.

ORDERING INFORMATION: Specify MR16 layout and lens in the options section of the part number. See right for Edge EX layout options. Sample Catalog #: EX4B-WW-O-T5-1-1-24-AC48G1-120-1C-W-M4M/LP.

EDGE EX Layout Options (Consult factory for EDGE E4 layout options)

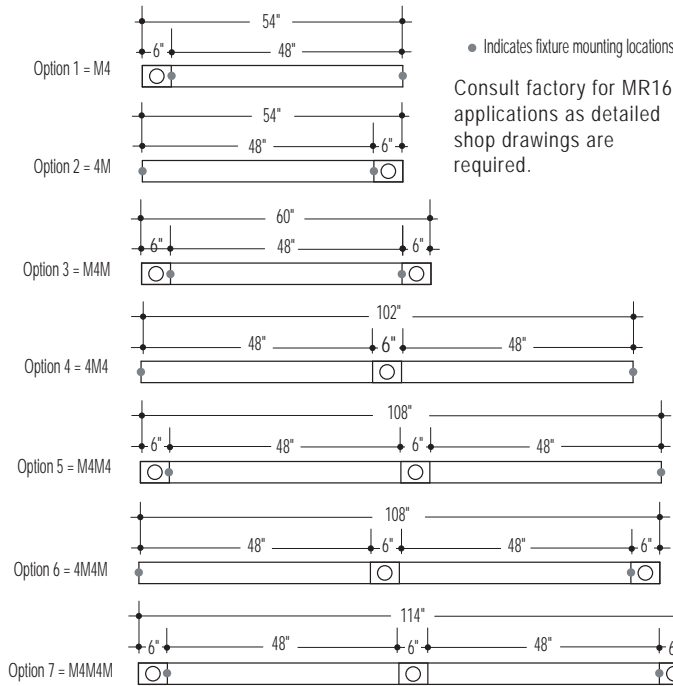

CIRCUITING

1C = All lamps on 1 circuit.*

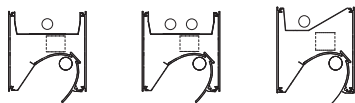

2C = Top and bottom lamps are on separate circuits.**

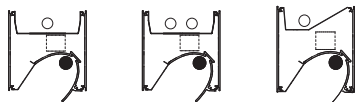

*1D= All lamps on 1 dimmed circuit

**2D = Top and bottom lamps are on separate dimmed circuits

Consult factory for emergency circuit (E) and battery pack (B) applications as detailed shop drawings are required.

BAFFLE

Baffle controls glare and provides lengthwise shielding of lamp. Curved baffles are highly reflective white painted aluminum. Baffles are field installed and feature a snap-in attachment. Specify Baffle (B) in the options section of the part number. Sample Catalog #: EX4B-WW-O-T5-1-2-24-AC48G1-120-1C-W-B.

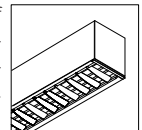

LENS

Lens is ideal for applications requiring lamp protection. Clear acrylic lens features a snap-in attachment allowing for easy lamp replacement. Specify Clear Acrylic Lens (LC) in the options section of the part number. Sample Catalog #: EX4B-WW-O-T5-1-2-24-AC48G1-120-1C-W-LC.

DUST GUARD

Dust Guard prevents particle ingress. Diffuse snap-in acrylic lens at top of fixture is easily removed for lamp replacement. Specify Dust Guard (DG) in the options section of the part number. Sample Catalog #: EX4B-WW-O-T5-1-2-24-AC48G1-120-1C-W-DG.