

**CONSTRUCTION** Extruded aluminum housing with cold rolled steel ends.

**REFLECTOR** Highly reflective die-formed specular anodized aluminum with asymmetric distribution.

**LENS** Standard clear tempered glass.

**ELECTRICAL** 120 volt only

**MOUNTING** Galvanized plate mounts to structure allowing for easy installation. Fixture head is fixed. Mounting cover plate is painted to match fixture housing unless otherwise specified.

**FINISH** Standard powder-coat textured white painted finish. Consult factory for custom color and finishes.

**LABELS** UL and cUL Listed and approved for dry/damp location.

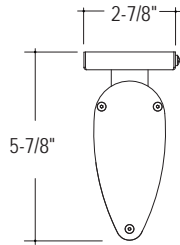
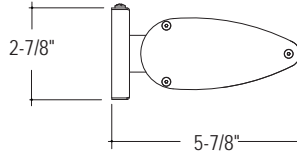

**LUMINAIRE SPECIFICATION**

Sample Catalog #: VU-Q100D-S-120-1C-W

V_-	Q___D-	S-	120-	1C-	___-	___
PRODUCT	LAMPS / LENGTH	MOUNTING	VOLTAGE	CIRCUITING	FINISH	OPTIONS
VU- Vertigo Linear indoor luminaire, indirect (UP)	Line Voltage (120V)  LAMP                      LENGTH Q100D- (1) 100W DC    6" Q150D- (1) 150W DC    6"	S- Surface Mount	120- 120 V	1C- Single Circuit <sup>1</sup>	W- Matte White S- Metallic Silver CC- Custom Color	
VD- Vertigo Linear indoor luminaire, direct (DOWN)				<sup>1</sup> Some Vertigo configurations will not accommodate all electrical options. Consult factory.		

**ROTATION**

Fixture head is in a fixed position. Fixture attaches to mounting plate and can be mounted as a direct (VD) or indirect (VU) light source. Specify up or down light source in the Product section of the part number.

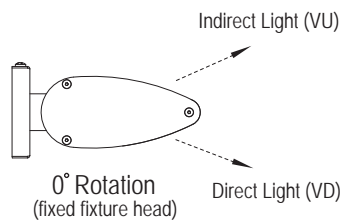

**MOUNTING DIMENSION**

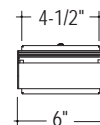

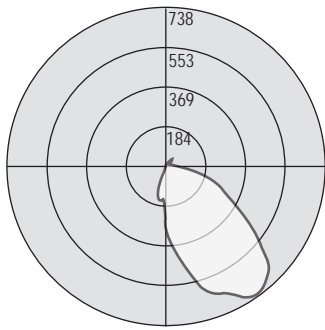

Test #15023  
 Catalog # VD-Q100D-S-1-W  
 Total Luminaire Efficiency = 76.20%

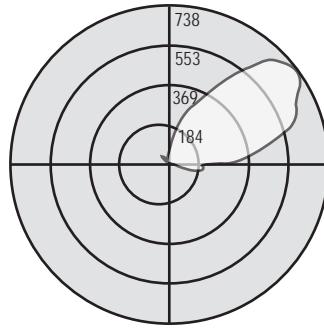

Test #15011  
 Catalog # VU-Q100D-S-1-W  
 Total Luminaire Efficiency = 76.20%

## MOUNTING DETAIL

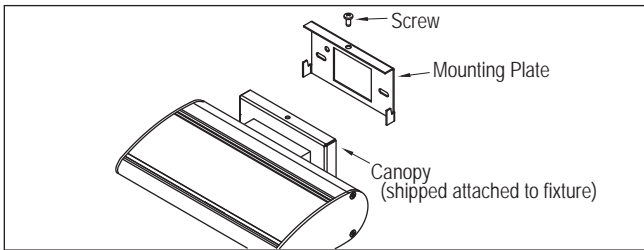

**Assembly:** Mounting plate attaches to horizontal switch box. Canopy fits over mounting plate and is secured through the top using one screw.