

**CONSTRUCTION** 6063-T5 Extruded aluminum housing. Highly reflective die-formed white painted aluminum reflector, .125" diffuse snap-in acrylic lens with matte finish, removable for lamp replacement.

**ELECTRICAL** Standard T5 and T5HO: Program start 120/277 volt integral electronic ballast with less than 10% THD. Through wiring with quick connects standard. Standard single circuit. Each ballast provided with disconnects to meet luminaire disconnect code requirement.

**MOUNTING** Aircraft cable, 1/2" diameter rigid stem pendant, wall and surface mount available. Adjustable aircraft cable mounts on 4'-0" 8'-0" and 12'-0" centers. Aircraft Cable supplied with 5" power and 2" non-power canopies. Refer to installation instructions for appropriate ceiling detail and rigid pendant details. Pendants, canopies, and power cords are painted white unless otherwise specified.

**FINISH** Standard powder-coat textured white painted finish. Consult factory for custom colors.

**LABELS** UL and cUL Listed, approved for dry/damp location unless otherwise noted.

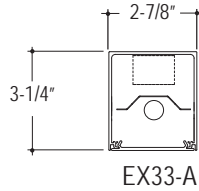

**LUMINAIRE SPECIFICATION**

Sample Catalog #: EX33-A-N-1T5-24-AC48G1-120-1C-W

| HOUSING                   | DIRECT             | INDIRECT           | LAMPS   | LENGTH | MOUNTING  | VOLTAGE   | CIRCUIT/WIRING   | FINISH                             | OPTIONS |
|---------------------------|--------------------|--------------------|---|--------|---|---|--|------------------------------------|---------|
| EX33-<br>Edge EX<br>3 x 3 |                    | N- None,<br>Closed | Individual Units<br>4- 4'<br>8- 8'<br>12- 12'<br>Continuous Runs<br>xx'- Specify nominal overall<br>row length in 4' increments |        |   | 120- 120 V<br>277- 277 V<br>347- 347 V<br>UNV- UNV<br>(120/277) |  | W- Matte White<br>CC- Custom Color |         |
|                           | A- Acrylic<br>Lens |                    | 1T5- (1) 28W T5<br>1T5HO- (1) 54W<br>T5HO   |        | Aircraft Cable <sup>1</sup><br>AC48G1- 1" T-Bar <sup>2</sup><br>AC48G9- 9/16" T-Bar <sup>2</sup><br>AC48GS- Slotted T-Bar <sup>2</sup><br>AC48JB- Junction Box<br>AC48ST- Structure<br>AC5_G_- 5" Non-Power Canopy <sup>3</sup><br>AC5_JB- 5" Non-Power Canopy <sup>3</sup><br>Pendant <sup>1</sup><br>PP_JB- Junction Box<br>(specify O.A.L., 12", 18" or 24")<br>PP_ST- Structure<br>(specify O.A.L., 12", 18" or 24")<br>Wall<br>WA- Wall Mount<br>Surface (Ceiling)<br>S- Ceiling Surface Mount |   | 1C- Single Circuit<br>1D- Single Circuit Dimming <sup>4</sup><br>1E- Single Circuit with<br>Emergency Circuit <sup>4</sup> |                                    |         |

<sup>1</sup>Consult factory for additional lengths.  
<sup>2</sup>Consult factory for tegular edged tiles.  
<sup>3</sup>Replaces standard 2" non-power canopy.  
<sup>4</sup>Some Edge EX configurations will not accommodate all electrical options. Consult factory.

**Individual Luminaires**

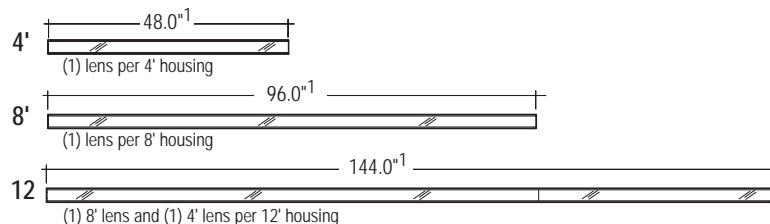

|     | T5      | T5HO    |
|-----|---------|---------|
| 4'  | 1 - 28W | 1 - 54W |
| 8'  | 2 - 28W | 2 - 54W |
| 12' | 3 - 28W | 3 - 54W |

<sup>1</sup>Add 1/16" for each end plate or 1/8" to the overall length of the row.

**Mounting Options**

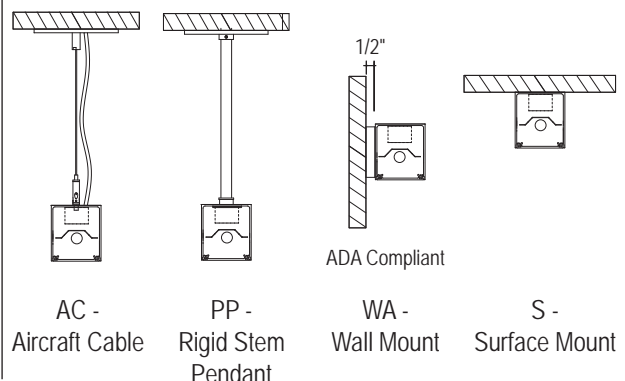

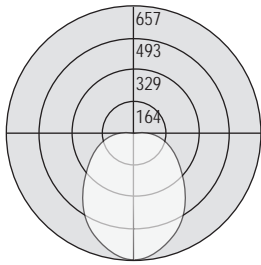

Test # 203077  
 Part # EX33-A-N-1T5  
 Total Luminaire Efficiency: 66.1%

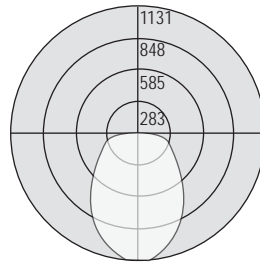

Test # 203078  
 Part # EX33-A-N-1T5HO  
 Total Luminaire Efficiency: 66.6%

FEATURES AND OPTIONS

• CIRCUITING

Single Circuit (1C) Layout

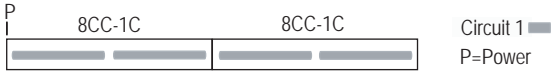

Single Circuit with Emergency Circuit (1E) Layout



• STANDARD ROW CONFIGURATION

Pinnacle Architectural Lighting utilizes standard row configurations for continuous runs.  
 Please consult factory if a project requires non-standard row configurations.

| Individual Length | Row Length |   |    |    |    |    |    |    |    |    |    |    |    |    |    |    |    |    |    |    |
|-------------------|------------|---|----|----|----|----|----|----|----|----|----|----|----|----|----|----|----|----|----|----|
|                   | 4          | 8 | 12 | 16 | 20 | 24 | 28 | 32 | 36 | 40 | 44 | 48 | 52 | 56 | 60 | 64 | 68 | 72 | 76 | 80 |
| 4'                | 1          |   |    |    |    |    |    |    |    |    |    |    |    |    |    |    |    |    |    |    |
| 8'                |            | 1 |    | 2  | 1  |    | 2  | 1  |    | 2  | 1  |    | 2  | 1  |    | 2  | 1  |    | 2  | 1  |
| 12'               |            |   | 1  |    | 1  | 2  | 1  | 2  | 3  | 2  | 3  | 4  | 3  | 4  | 5  | 4  | 5  | 6  | 5  | 6  |