

Adeo T5/T8 Surface Mount

For Lamp/Ballast Maintenance See Separate Maintenance Sheet

Step 1: Remove Ballast Cover

1. Located lens notch and pull lens down from that side.
2. Remove (2) #8-32 screws.
3. Pull ballast tray down to remove it from fixture.

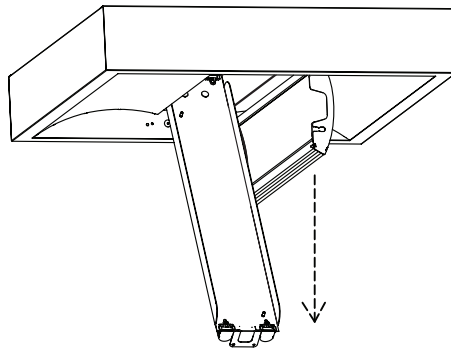
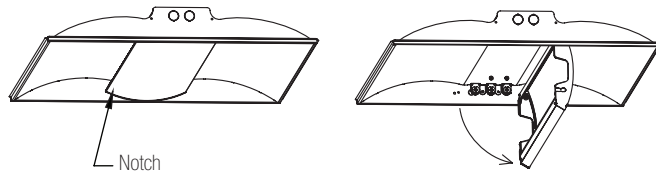
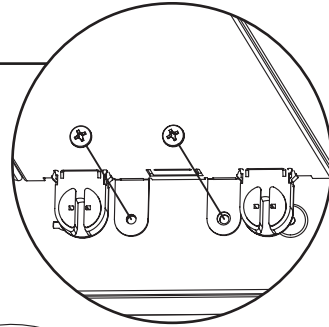

Step 2: Making the Connections

1. Using the power cord from the fixture make necessary wiring connections to building power.
2. After making connections recess the wires into the J-Box and cover with appropriate canopy (by others).

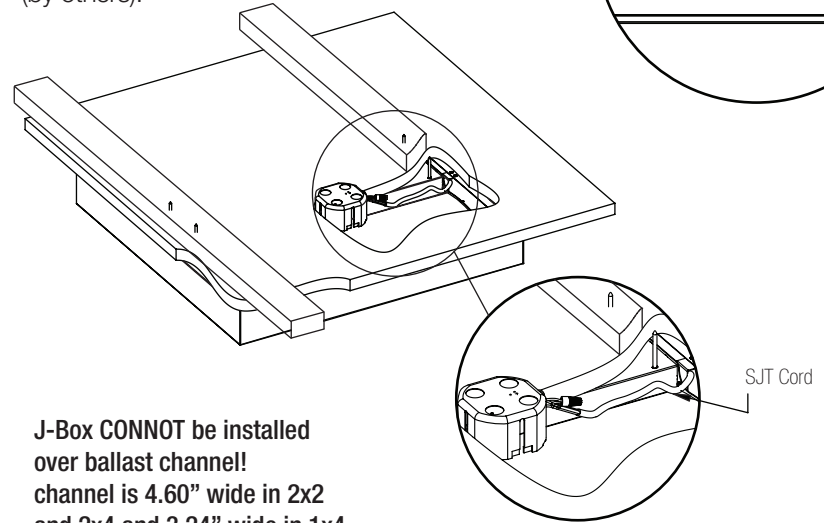
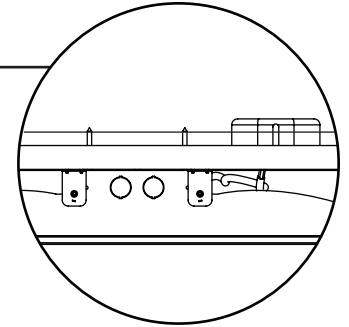

J-Box CANNOT be installed over ballast channel!
channel is 4.60" wide in 2x2 and 2x4 and 3.24" wide in 1x4

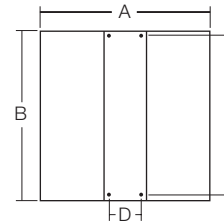

Fixture Size	Dim "A"	Dim "B"	Dim "C"	Dim "D"
1x4	13-1/2"	49-1/2"	40"	2-3/5"
2x2	25-1/2"	25-1/2"	21"	4"
2x4	25-1/2"	49-1/2"	45"	4"

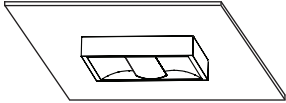

Adeo T5/T8 Surface Mount

For Lamp/Ballast Maintenance See Separate Maintenance Sheet

Step 3: Mounting / Finishing.

1. Inside ballast channel locate holes in corners (one in each corner).
2. Using these holes (4) mount fixture to structure with appropriate mounting hardware (by others).
3. Re-install ballast cover, Install lamps, close fixture.

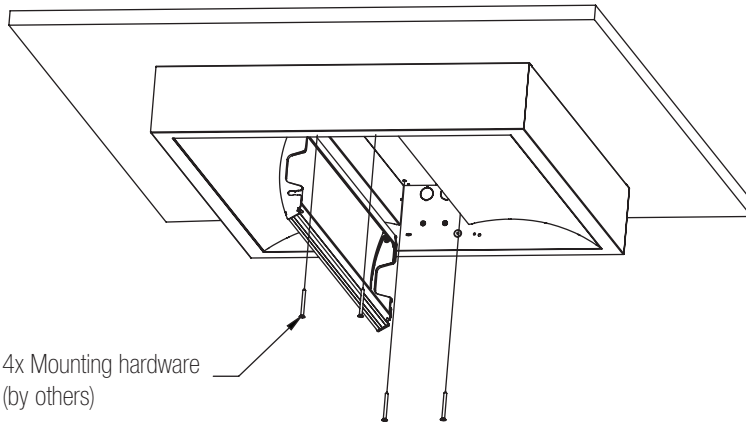
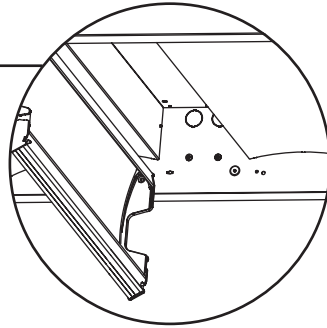

Step 4 Installing Lamps

1. Locate notch on lens endcap, pull down from notched side of lens to open.
2. Lens remains captive to fixture for lamp installation and maintenance.

